

PHS-16B PCB mounting 6-way RCA Phono connector. Several different coloured inserts available. Nickel Silver or Gold plated finish.
PHS-16B (Various)

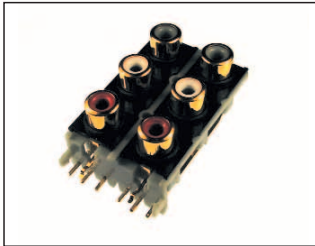

PHS-16C PCB mounting 6-way RCA Phono connector. Several different coloured inserts available. Nickel Silver or Gold plated finish.
PHS-16C (Various)

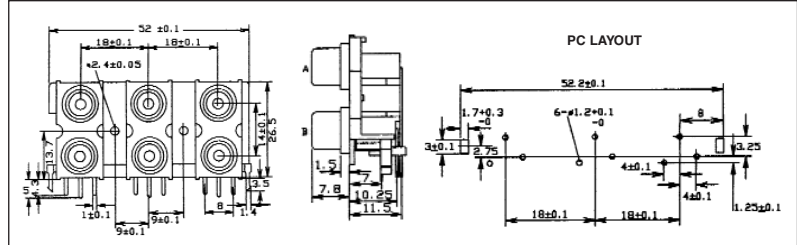
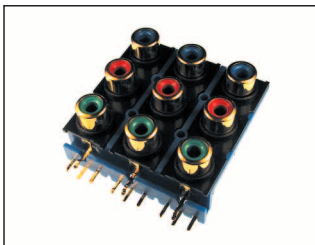
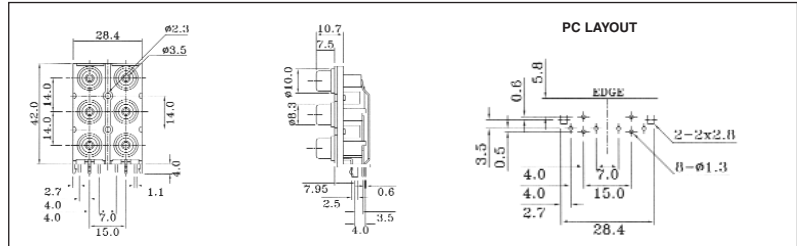

PHS-19A PCB mounting 9-way RCA Phono connector. Several different coloured inserts available. Nickel Silver or Gold plated finish.
PHS-19A (Various)

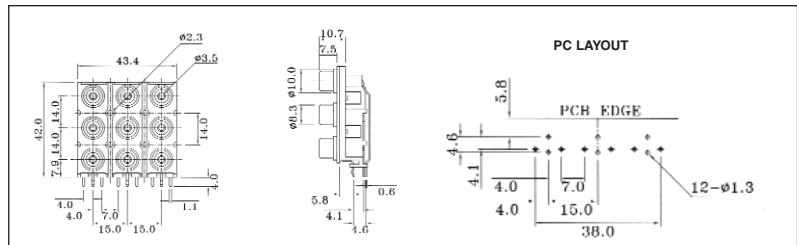

Electrical Specifications:

Contact Resistance: 30mΩ max. @ AC 100mA max. 1kHz

Dielectric Withstand: 500Vac @ 60 Hz for 1 minute.

Insulation Resistance: <100mΩ min. @ 500 Vdc.

Mechanical Specifications:

Insertion Life (Minimum): >4000 insertions and removals

Insertion Force: 0.03~3.0Kg

Extraction Force: 0.03~3.0Kg

Materials:

Housing: Thermoplastic

Contacts: Copper Alloy

Barrel: Copper Alloy

Front Metal Shield: Copper Alloy

Spring Shield: Stainless

Plating: Choice of Nickel Silver and Gold



CLIFF

RCA Phono Connectors PCB Mounting

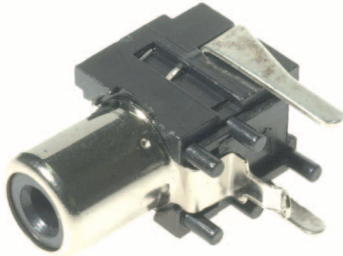

PHS-2A



PHS-10B

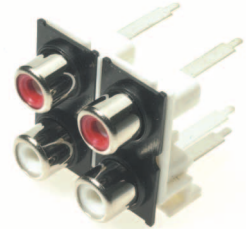

PHS-12D

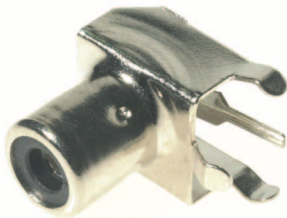

PHS-6A



PHS-10V

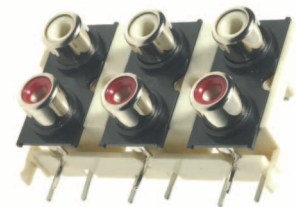

PHS-16B



PHS-10D

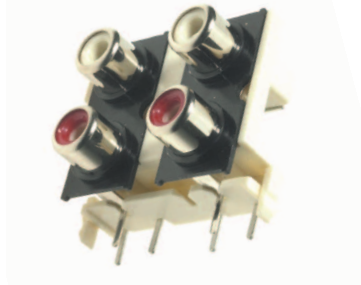

PHS-14B

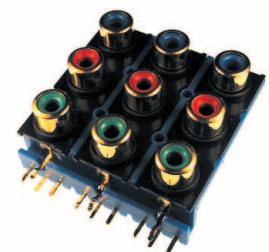

PHS-19A

The **CLIFF**[®] range of single, dual, quad and multiple PCB mounting RCA connectors provide a low cost and reliable connection system. They are intended for use in many types of consumer and professional audio equipment. Metal parts are available nickel plated (standard) or with a gold finish and with a choice of coloured inserts for identification purposes. Models are available for both vertical and horizontal PCB mounting. Snap-in legs facilitate assembly and wave soldering. Some versions can be supplied with a prefitted EMI/RFI screen if required.

Cliff Electronic Components, Ltd.

76 Holmethorpe Avenue, Holmethorpe Ind. Est.

Redhill, Surrey RH1 2PF. England

Tel: +44 (0) 1737 771375

Fax: +44 (0) 1737 766012

Email: sales@cliffuk.co.uk



Visit us online at:

www.cliffuk.co.uk

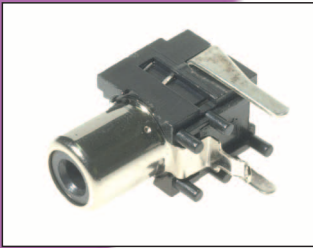

PHS-2A PCB mounting RCA Phono connector with break contact.
PHS-2B version without break contact.
PHS-2A (FC6837)
PHS-2B (FC68371)

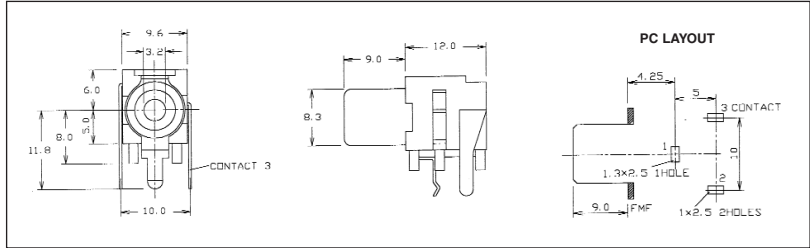

PHS-4B Snap In PCB mounting RCA Phono connector.
Only available with black insert.
PHS-4B (FC68375)

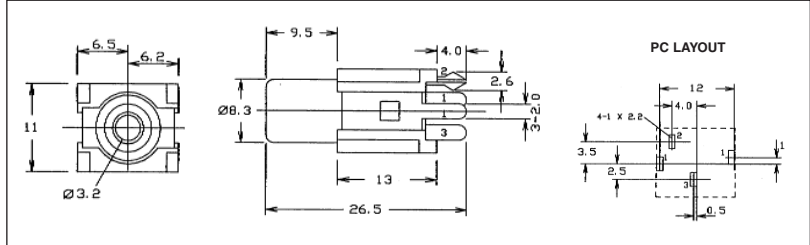

PHS-6A PCB mounting RCA Phono connector.
Several different coloured inserts available. Nickel Silver or Gold plated finish.
PHS-6A (Various)

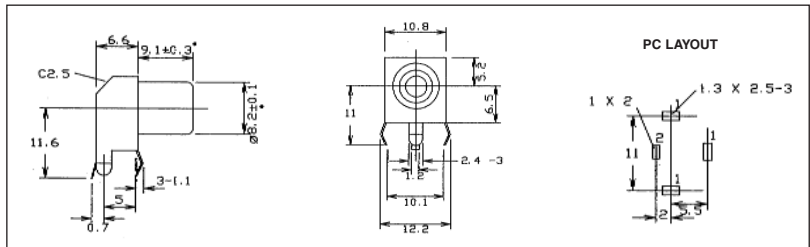

PHS-7A Vertical PCB mounting RCA Phono connector.
Several different coloured inserts available. Nickel Silver or Gold plated finish.
PHS-7A (FC68400)

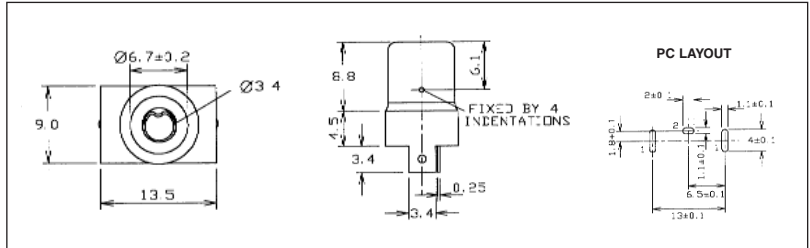

PHS-10A PCB mounting RCA Phono connector.
Several different coloured inserts available. Nickel Silver or Gold plated finish.
PHS-10A (Various)

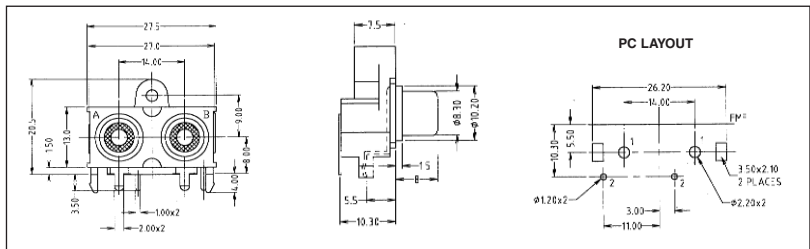

PHS-10B PCB mounting dual RCA Phono connector.
Several different coloured inserts available. Nickel Silver or Gold plated finish.
PHS-10B (Various)

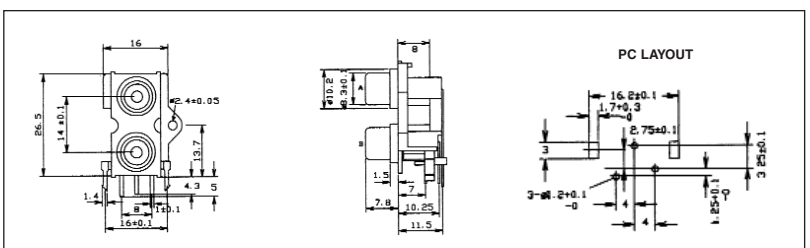

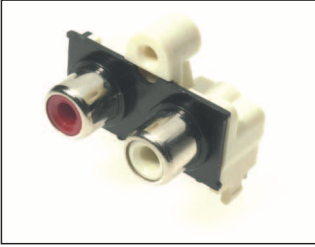

PHS-10D PCB mounting dual RCA Phono connector. Several different coloured inserts available. Nickel Silver or Gold plated finish.
PHS-10D (Various)

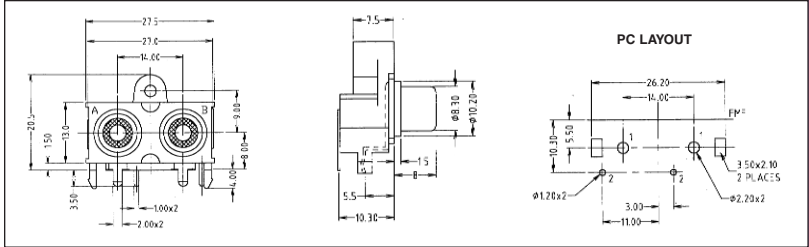

PHS-10V vertical PCB mounting dual RCA Phono connector. Nickel Silver or Gold plated finish.
PHS-10V (Various)

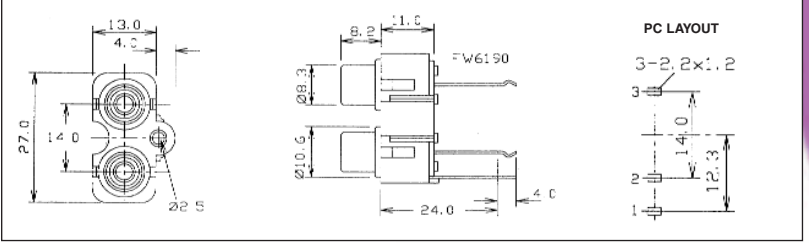

PHS-10W vertical PCB mounting RCA Phono connector. Nickel Silver or Gold plated finish.
PHS-10W (Various)

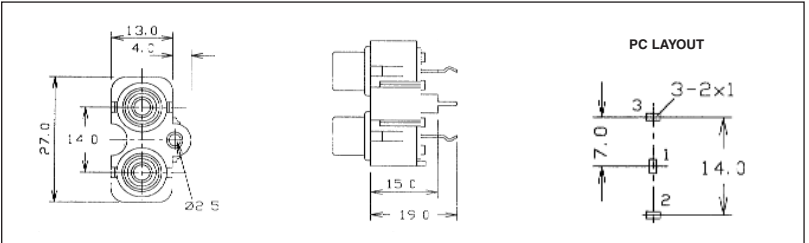

PHS-12D vertical PCB mounting Quad RCA Phono connector. Nickel Silver or Gold plated finish.
PHS-12D (Various)

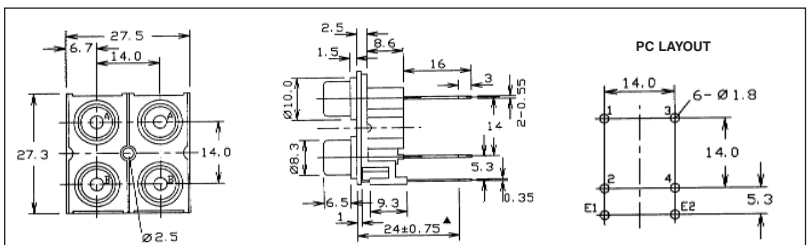

PHS-14B PCB mounting Quad RCA Phono connector. Several different coloured inserts available. Nickel Silver or Gold plated finish.
PHS-14B (Various)

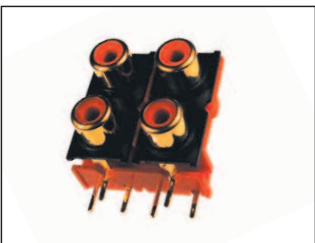
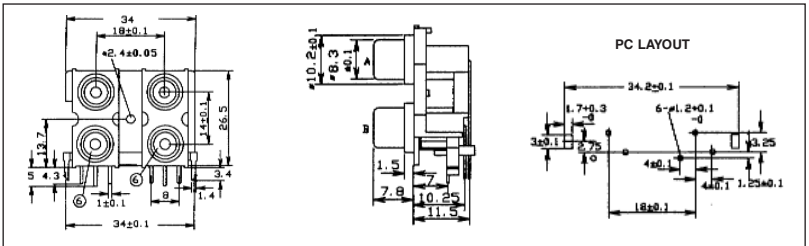

PHS-14D PCB mounting Quad RCA Phono connector. Several different coloured inserts available. Nickel Silver or Gold plated finish.
PHS-14D (FC684784)

