

FEATURES AND SPECIFICATIONS

Features and Benefits

- Environmentally sealed to IP67
- Integrated terminal position assurance (TPA)
- Simple crimp-and-poke application
- Field serviceable contact removal system
- Tactile and audible mating feedback
- For outside or inside panel mount application
- Use with molded silicon panel gasket

Reference Information

UL File No.: E152602

Designed In: Inches

Mates With: 19418

Electrical

Dielectric Withstanding Voltage: 2200V AC min.

Insulation Resistance: 1000 Megohms

Voltage: 600V

Mechanical

Mating force: 75N max.

Unmating force: 75N max.

Physical:

Housing: SPS Glass-Filled Crystalline Polymer

Operating Temperature: -40 to +125°C



5.84mm (.230") Pitch MX150L™ Panel Mount Plug

19429

Through Hole Flange Dual Row

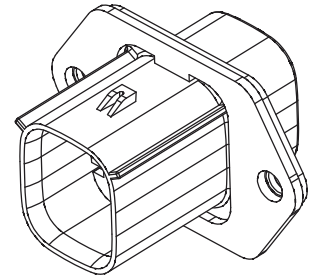

CATALOG DRAWING (FOR REFERENCE ONLY)

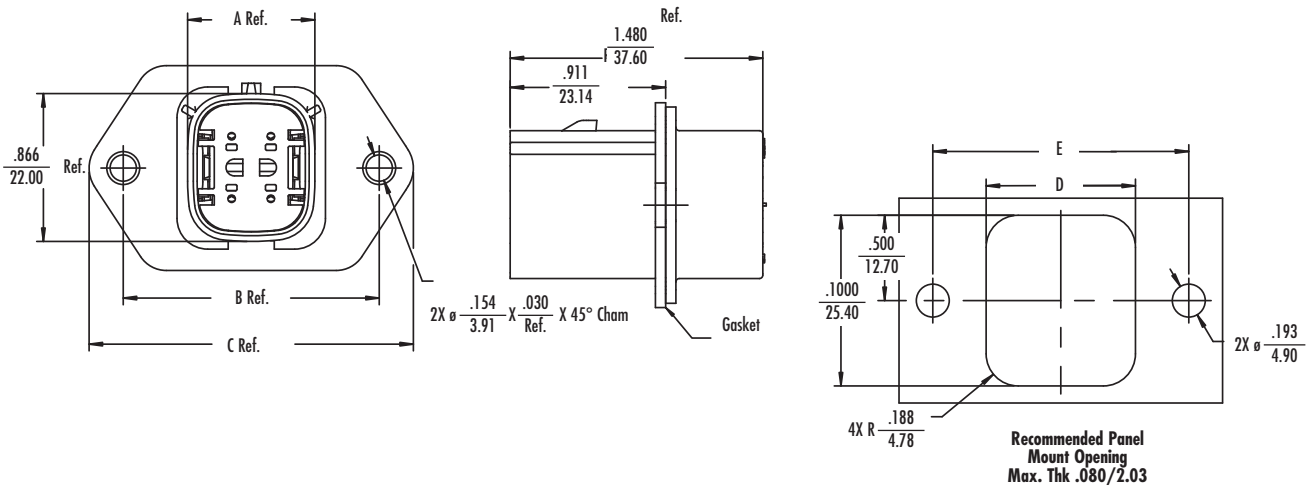

ORDERING INFORMATION

Circuits	Wire Range (AWG)	Order No.			Dimension				
		With Gasket	Without Gasket	Gasket	A	B	C	D	E
4	14-22	19429-0043	19429-0025	19427-0024	16.10 (.634)	38.10 (1.500)	48.26 (1.900)	22.23 (.875)	38.10 (1.500)
6		19429-0044	19429-0028	19427-0021	24.78 (.976)	41.92 (1.650)	52.08 (2.050)	28.07 (1.105)	41.92 (1.650)
8		19429-0045	19429-0029	19427-0022	30.62 (1.206)	48.26 (1.900)	58.42 (2.300)	33.88 (1.334)	48.26 (1.900)
10		19429-0046	19429-0030	19427-0029	36.47 (1.436)	54.61 (2.150)	64.75 (2.549)	39.75 (1.565)	54.61 (2.150)
12		19429-0047	19429-0031	19427-0030	42.31 (2.400)	60.96 (2.400)	70.97 (2.794)	45.59 (1.795)	60.96 (2.400)
16		19429-0048	19429-0032	19427-0023	53.99 (2.126)	73.67 (2.900)	83.83 (3.300)	57.28 (2.255)	73.67 (2.900)



MX150L™

Product Overview

14 TO 22 AWG WIRE-TO-WIRE, PANEL MOUNT AND PCB

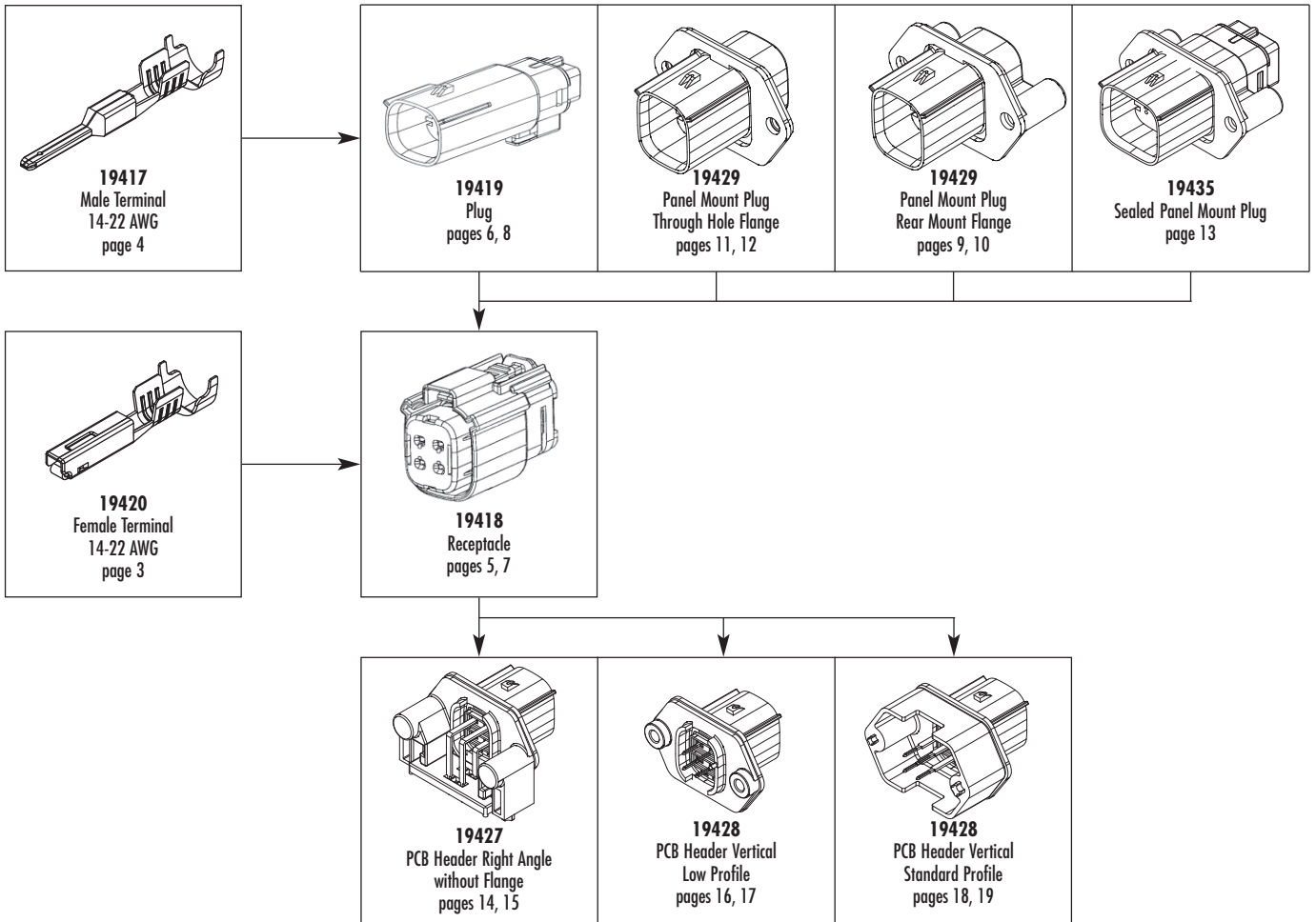

8, 10 AND 12 AWG WIRE-TO-WIRE

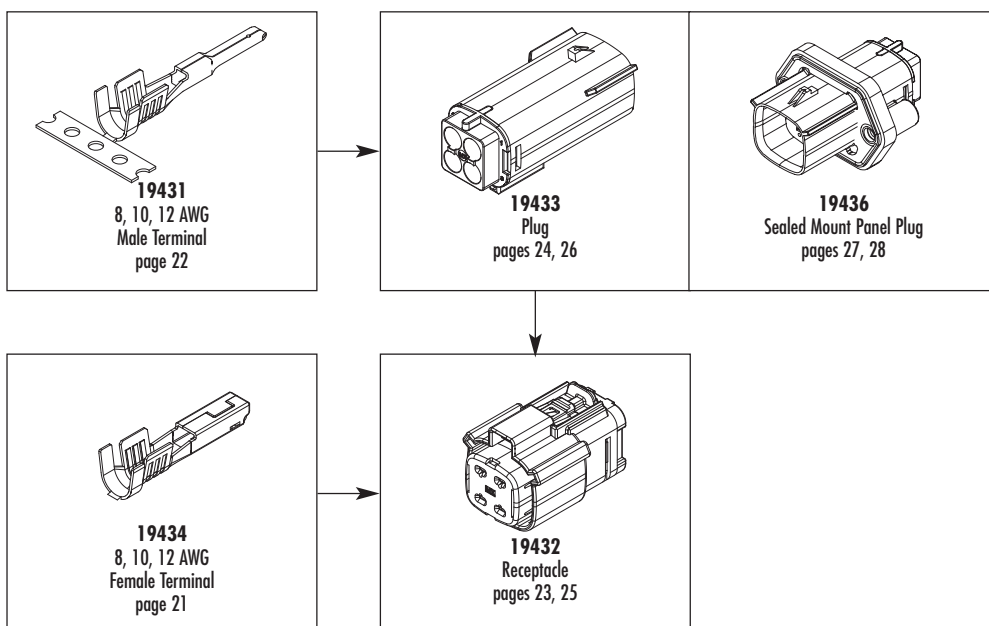

SEALED RECEPTACLE ASSEMBLY - SERVICEABILITY



1) Return TPA to pre-lock position

- Carefully insert a standard screw driver into slot on top of TPA.
- Carefully pry TPA forward and listen for audible click.
- TPA is now in pre-lock position.

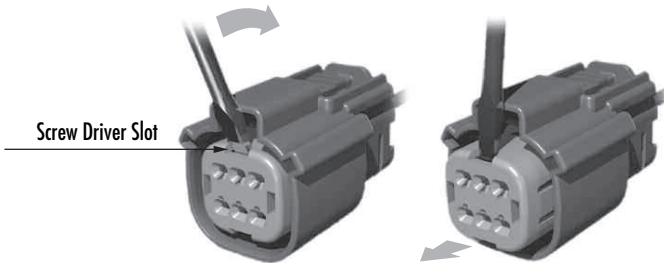

2) Release terminal from connector assembly

- Insert and drive forward extractor tool to release terminal.
- Pull terminal from rear of connector.

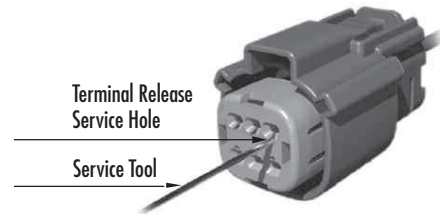

SEALED BLADE ASSEMBLY - SERVICEABILITY

1) Return TPA to pre-lock position

- Use standard needle nose pliers to return TPA to pre-lock position.
- Insert needle nose pliers into service hole and carefully pull TPA.
- Listen for loud audible click.
- TPA is now in pre-lock position.

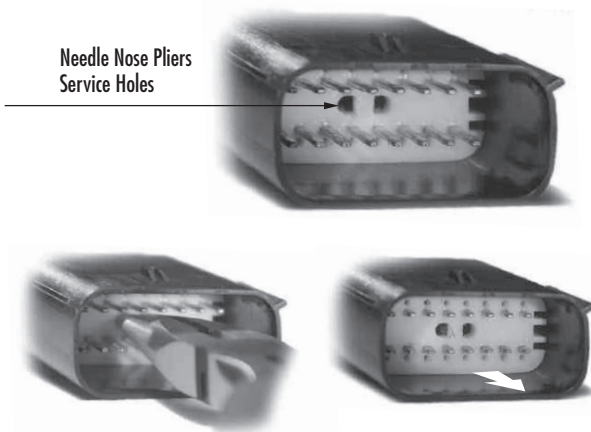

2) Release terminal from connector assembly

- Insert and drive forward extractor tool to release terminal.
- Pull terminal from rear of connector.

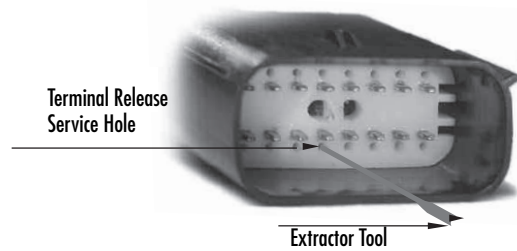

TERMINAL INSTALLATION

Assure housing TPA is in pre-lock position. Align polarization feature on terminal with keyway in seal cap. Insert terminal and push until seated. Push receptacle TPA back to locked position. Plug TPA will return to locked position when mated with receptacle housing.

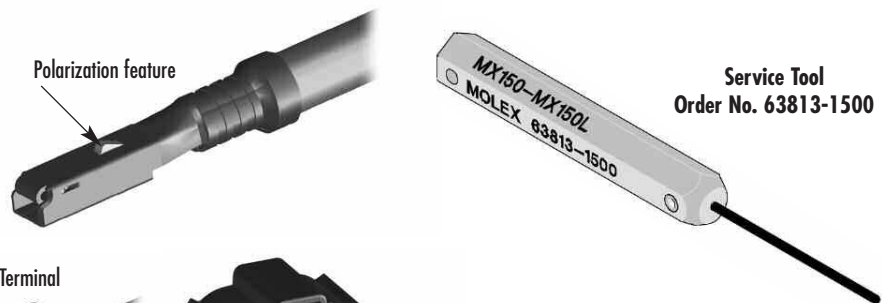

90° Mis-oriented Terminal



180° Mis-oriented Terminal



Correctly oriented Terminal



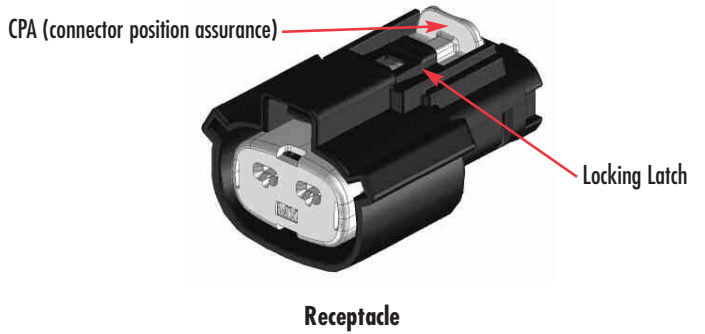
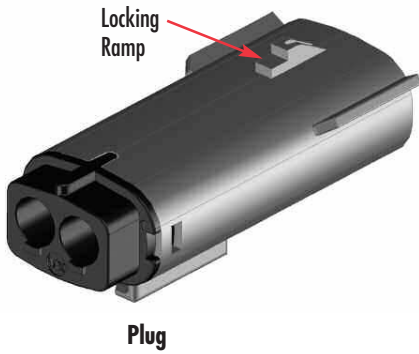

To Mate:

1. Firmly push connectors together until you feel them snap together, you should hear a click. This audible and tactile confirmation ensures the connectors are properly and fully mated.

2. Press CPA towards plug to engage the secondary lock.

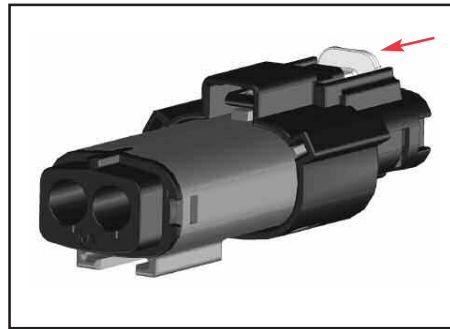
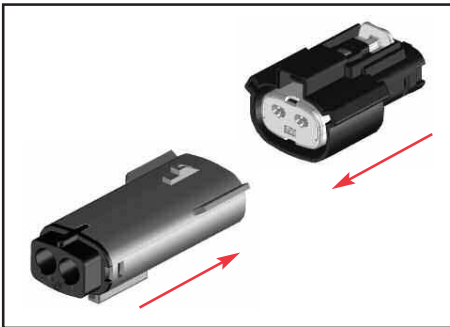

To Unmate:

1. Pull back CPA

2. Fully depress locking latch

Locking latch must be fully depressed to release the locking ramp on the plug and allow the connectors to be separated!

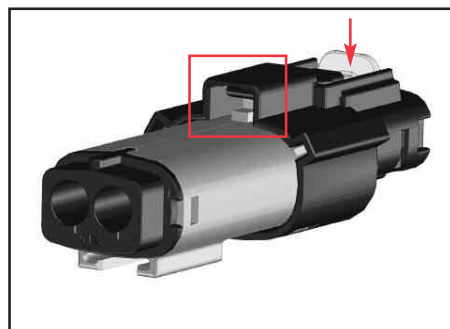
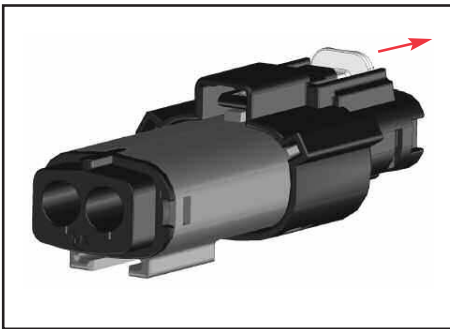

3. Pull connectors apart

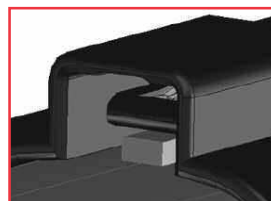
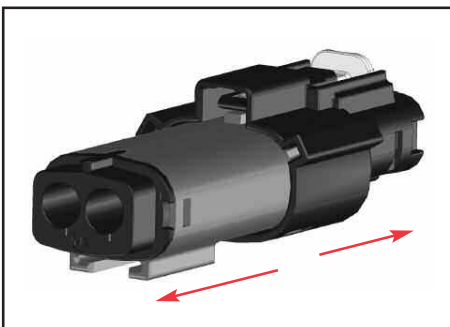

Locking latch shown down, cannot unmate connectors

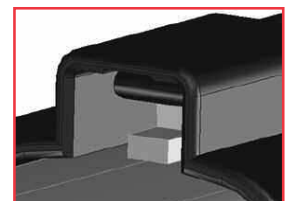

Locking latch shown fully depressed, latch releases locking ramp



MX150L™ Sealed

Connector System





MX150L™ Sealed Connector System

The pre-assembled, submersible MX150L is a high performance connector system suitable for challenging, rugged and harsh applications.

The MX150L sealed connector system is designed to meet the need for a rugged, environmentally sealed connector system supporting both low-level signal applications as well as power applications up to 40.0A, from on-engine automotive and marine applications to off-road construction equipment applications. The system is comprised of wire-to-wire, wire-to-panel and wire-to-board configurations.

These innovative mat-sealed connectors are based upon the 1.50 and 2.50mm (.059 and .098") blade-type terminals. This design eliminates the need to purchase, handle and crimp individual wire seals to lower applied cost. The mat-seal design is a single silicone-based seal with individual wire openings and a seal cap to protect, securely retain, and provide strain relief to the seal. The cost-effective connector design features all-in-one plug and receptacle housings with pre-assembled mat-wire and interfacial connector seals. Integral Terminal Position Assurance (TPA) and optional Connector Position Assurance (CPA) components eliminate

time-consuming and costly assembly operations. Completing the application is as simple as crimping the appropriate terminal, inserting the crimped terminal lead and seating the TPA to its final locked position. No additional components are required.

Tooling solutions include FineAdjust™ crimp press applicators for high-volume production, as well as hand tools for low-volume production and field repairs.

FEATURES AND BENEFITS

- Pre-assembled connector housings, seals, TPA components and mat-seal cap shipped in one piece to provide applied labor and cost savings
- Audible and tactile clicks on insertion, extraction and mating feedback facilitates reliable mating and terminal loading and removal
- Integral, 2-way mat and interface seals designed and tested to IEC IP 67 and SAE USCAR-2, Rev. 3 standards exceeds "waterproof" demands as a true sealed connector system tested under submersed conditions in various fluids
- Integral TPA assures that crimped terminal leads are properly locked into connector (TPA will not seat into final lock position and connector system will not latch if terminal is not locked properly into position)
- Unused circuits can be blocked using plastic seal plugs, which facilitates flexibility of sealing unused circuits without adding complexity to part numbers and customer inventory
- Easy terminal insertion and extraction provides quick, low-cost field repairs using common screw driver, needle nose pliers and terminal extraction tool
- Conforms to UL 1977, which allows for a UL recognized sealed connector system for use in data, signal, control and power applications
- Protective mat-seal cap protects, securely retains, and provides strain relief to wire seal interface
- Superior electrical and mechanical performance capabilities surpass performance of most mature competitive products in market
- Sealed panel mount plugs are equipped with a blind hole boss feature which reduces extra hardware while improving the sealing process during assembly by eliminating a leak path
- Simple crimp, poke and plug application eliminates need to crimp individual wire seals

MX150L SEALED CONNECTOR SYSTEMS - EXPLODED VIEW

Receptacle Connector

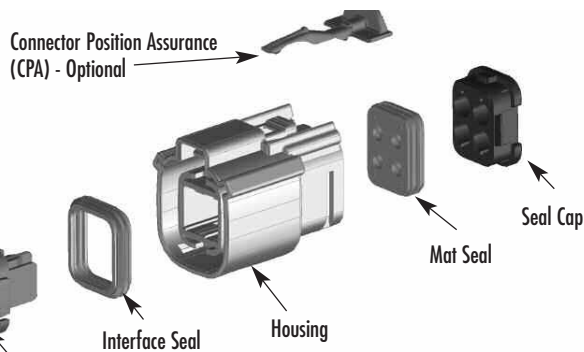

Plug Connector

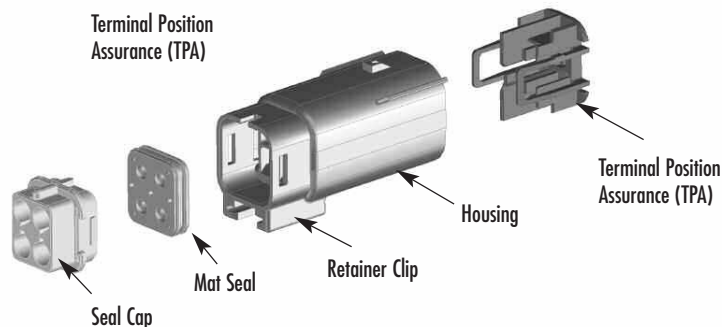

NOTE: All discrete components shown above for both the receptacle and plug housings are pre-assembled. Terminals are simply crimped and poked into the housings. No additional wire seals, wedge locks or CPA locks are required.