



Inductive proximity sensors

IH 34 series, sensing range 30 mm

AC / DC 2-wire, plastic housing

Dimensions in mm

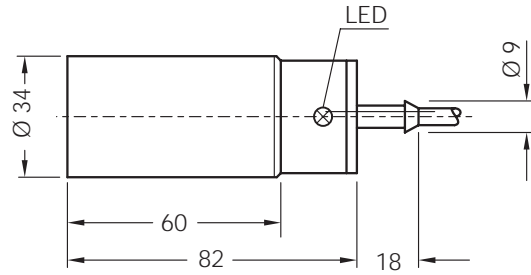

Features



- ▶ Can be installed non-flush in metal
- ▶ Enhanced sensing range
- ▶ Broad operating voltage range in AC and DC
- ▶ Normally open/ normally closed function
- ▶ Plastic housing
- ▶ Enclosure rating IP 67
- ▶ LED status indicator

Accessories

- ▶ Mounting clamps incl.

Connection diagram

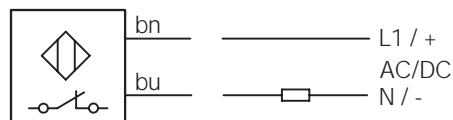
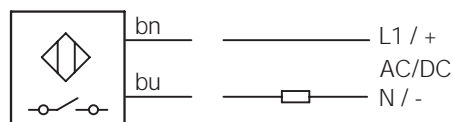

Wire colour	Assignment
bn brown	L1 / +
bu blue	N / -

Electrical and mechanical data

Operating voltage U_b	20 ... 250 V AC / DC	Wire-break protection	-
Voltage drop U_d (at I_a max.)	≤ 6.5 V AC / ≤ 6 V DC	Short-circuit protection (pulsed)	-
Continuous current I_a	≤ 350 mA AC (... + 50 °C) ≤ 250 mA AC (... + 80 °C) ≤ 100 mA DC	Reverse polarity protection	-
Peak current I_k	2.2 A (20ms / 0.5 Hz)	Power-up pulse suppression	yes
Min. load current	5 mA	Enclosure rating to EN 60529	IP 67
Residual current	≤ 2.5 mA (250 V AC) ≤ 1.3 mA (110 V AC) ≤ 0.8 mA (24 V DC)	Protection class	□
Time delay before availability t_v (with s_n 20 / 30 mm)	approx. 8 / 50 ms	Shock and vibration stress	30 g, 11 ms 10 to 55 Hz, 1 mm
Hysteresis H	1% - 15% of s_r	Ambient temperature T_a	- 25 ... + 80 °C
Repeatability R (U_b and T_a constant)	$\leq 10\%$ of s_r	Housing material	Plastic
Temperature drift	$\pm 10\%$ of s_r	Connection cable	PUR-PVC, 2 x 0.5 mm ²
EMC	to EN 60 947-5-2		

Selection table

Sensing range s_n mm	Installation in metal	Output function	Switching frequency f in Hz	Connection	Type	Order number
30			7	Cable 2 m	IH34-30NUS-KU0	7902134
30			7	Cable 2 m	IH34-30NUO-KU0	7902135