

Type
183000

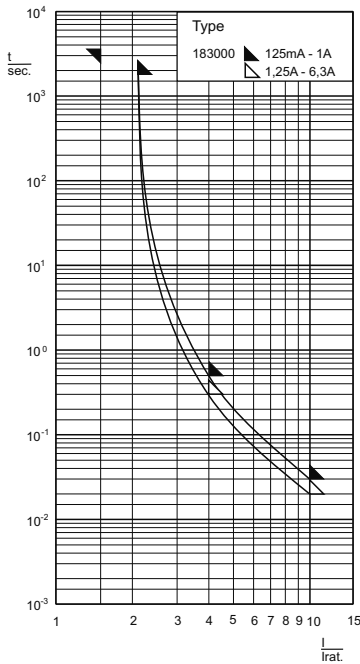

Zeit/Strom-Kennlinien
Time-Current Characteristics

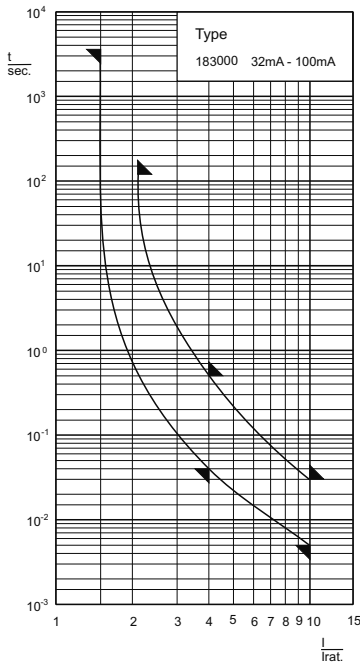

Abmessungen
Dimensions

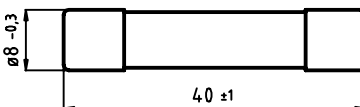

Aufbau / Construction

Glasrohr (bis 100 mA) / glass tube (up to 100 mA)
Keramikrohr (ab 100 mA) / ceramic tube (from 100 mA)
Kontaktgaps / end caps

durchsichtig / transparent
undurchsichtig / non-transparent
Messing, vernickelt / brass, nickel-plated

Schmelzeitgrenzwerte / Fusing time limits

Bemessungsstrom Rated Current	1,5 I _n		2,1 I _n		4 I _n		10 I _n	
	min.	max.	min.	max.	min.	max.	min.	max.
32 mA - 100 mA	1 h	-	-	2 min	40 ms	500 ms	5 ms	30 ms
125 mA - 1 A	1 h	-	-	30 min	-	400 ms	-	30 ms
1,25 A - 6,3 A	1 h	-	-	30 min	-	300 ms	-	20 ms

DIN 41686	8 x 40 mm	500 V	M mittelträge / med. time-lag F flink / quick acting
-----------	------------------	-------	---

Artikel-Nr. Article-no.	Bemessungsstrom Rated Current	Bemessungs-Ausschaltvermögen Rated Breaking Capacity	Spannungsfall Voltage Drop	Leistungsabgabe Power Dissipation	Schmelzintegral I ² t ₅₀ Value	Charakteristik Characteristic	Approbationen Approvals
			mV max.	mW	A ² s		
183000.0,032	32 mA	80 A @ AC 500 V	2300	1)	1)	M	
183000.0,05	50 mA	80 A @ AC 500 V	1600	1)	1)	M	
183000.0,063	63 mA	80 A @ AC 500 V	1300	1)	1)	M	
183000.0,08	80 mA	80 A @ AC 500 V	950	1)	1)	M	
183000.0,1	100 mA	80 A @ AC 500 V	700	1)	1)	M	
183000.0,125	125 mA	1500 A @ AC 500 V	6300	1)	1)	F	
183000.0,16	160 mA	1500 A @ AC 500 V	4700	1)	1)	F	
183000.0,2	200 mA	1500 A @ AC 500 V	3600	1)	1)	F	
183000.0,25	250 mA	1500 A @ AC 500 V	2800	1)	1)	F	
183000.0,315	315 mA	1500 A @ AC 500 V	2100	1)	1)	F	
183000.0,4	400 mA	1500 A @ AC 500 V	1600	1)	1)	F	
183000.0,5	500 mA	1500 A @ AC 500 V	1250	1)	1)	F	
183000.0,63	630 mA	1500 A @ AC 500 V	1000	1)	1)	F	
183000.0,8	800 mA	1500 A @ AC 500 V	800	1)	1)	F	
183000.1	1 A	1500 A @ AC 500 V	620	1)	1)	F	
183000.1,25	1,25 A	1500 A @ AC 500 V	520	1)	1)	F	
183000.1,6	1,6 A	1500 A @ AC 500 V	450	1)	1)	F	
183000.2	2 A	1500 A @ AC 500 V	400	1)	1)	F	
183000.2,5	2,5 A	1500 A @ AC 500 V	370	1)	1)	F	
183000.3,15	3,15 A	1500 A @ AC 500 V	340	1)	1)	F	
183000.4	4 A	1500 A @ AC 500 V	320	1)	1)	F	
183000.5	5 A	1500 A @ AC 500 V	310	1)	1)	F	
183000.6,3	6,3 A	1500 A @ AC 500 V	300	1)	1)	F	

1) auf Anfrage / On request

Type	Abk. Abbr.	Beschreibung Description
		- 25 Stück / Pieces