



SS224

**3/4" Square Drive Stainless Steel
Sockets with Metric Hex Profile**



PRODUCT DETAILS

- AISI 420 stainless steel body
- Magnetic
- High strength and hardness
- Can be Autoclave Sterilized at 121°C
- Produced according to ISO 1174-1, ISO 1171-1 and ISO 2725-1

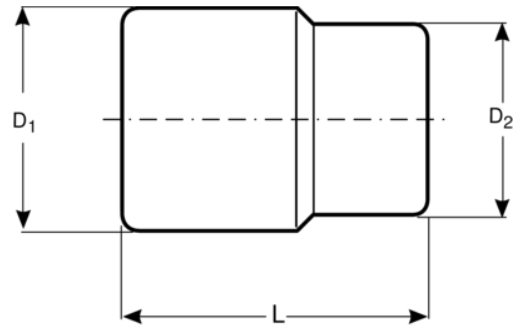

Follow the Fish!



PRODUCT ATTRIBUTES

Product		L	D1	D2	
SS224-17	17 mm	50 mm	38 mm	28 mm	215 g
SS224-19	19 mm	50 mm	38 mm	30 mm	225 g
SS224-22	22 mm	55 mm	38 mm	33 mm	253 g
SS224-24	24 mm	55 mm	40 mm	35 mm	290 g
SS224-27	27 mm	55 mm	40 mm	39 mm	300 g
SS224-30	30 mm	60 mm	43 mm	43 mm	375 g
SS224-32	32 mm	60 mm	45 mm	45 mm	415 g
SS224-34	34 mm	60 mm	45 mm	48 mm	450 g
SS224-36	36 mm	60 mm	45 mm	50 mm	458 g
SS224-41	41 mm	65 mm	48 mm	57 mm	640 g
SS224-46	46 mm	65 mm	50 mm	63 mm	735 g
SS224-50	50 mm	70 mm	50 mm	68 mm	790 g
SS224-55	55 mm	75 mm	52 mm	74 mm	820 g
SS224-60	60 mm	75 mm	52 mm	81 mm	850 g
SS224-65	65 mm	80 mm	52 mm	87 mm	850 g

