

# ELECTRONIC COMPONENT ACCESSORIES

## RT Series Toroidal Cores

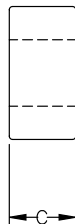
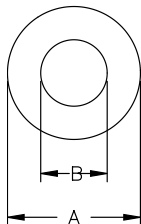
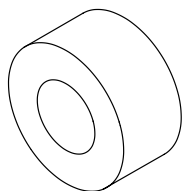

### Features

- The ring configuration provides for the ultimate in utilization of the ferrite material properties
- Can be used across in a wide frequency range
- The RT type ferrite core is mainly used as a multi-turn suppression core

*For performance and mechanical data on these parts please ask for our "Ferrite Typical Data Sheet."*

Material: Core Materials: K5B, A5, A6 • Color: Gray							
Part Number	Dimensions			Impedance ( $\Omega$ at 100 Mhz)			Standard Pack per Bag
	"A"	"B"	"C"	K5B	A5	A6	
RT040-010-035	.157 (4.0 mm)	.039 (1.0 mm)	.138 (3.5 mm)	—	—	—	TBD
RT040-020-015	.157 (4.0 mm)	.079 (2.0 mm)	.059 (1.5 mm)	—	—	25 Ohms	4000
RT040-020-020	.157 (4.0 mm)	.079 (2.0 mm)	.079 (2.0 mm)	—	—	35 Ohms	4000
RT040-020-030	.157 (4.0 mm)	.079 (2.0 mm)	.118 (3.0 mm)	39 Ohms	—	—	4000
RT041-016-040	.161 (4.1 mm)	.063 (1.6 mm)	.157 (4.0 mm)	—	60 Ohms	—	2000
RT044-028-014	.173 (4.4 mm)	.110 (2.8 mm)	.055 (1.4 mm)	—	—	63 Ohms	5000
RT050-020-040	.197 (5.0 mm)	.079 (2.0 mm)	.157 (4.0 mm)	—	—	38 Ohms	2000
RT060-030-020	.236 (6.0 mm)	.118 (3.0 mm)	.079 (2.0 mm)	—	—	34 Ohms	2000
RT060-030-040	.236 (6.0 mm)	.118 (3.0 mm)	.157 (4.0 mm)	46 Ohms	—	—	1000
RT065-043-060	.256 (6.5 mm)	.169 (4.3 mm)	.236 (6.0 mm)	41 Ohms	—	—	1000
RT070-035-040	.276 (7.0 mm)	.138 (3.5 mm)	.157 (4.0 mm)	46 Ohms	—	—	TBD
RT080-040-040	.315 (8.0 mm)	.157 (4.0 mm)	.157 (4.0 mm)	45 Ohms	—	—	1000
RT085-050-030	.335 (8.5 mm)	.197 (5.0 mm)	.118 (3.0 mm)	—	—	33 Ohms	1000
RT090-050-030	.354 (9.0 mm)	.197 (5.0 mm)	.118 (3.0 mm)	37 Ohms	—	55 Ohms	1000
RT090-050-080	.354 (9.0 mm)	.197 (5.0 mm)	.315 (8.0 mm)	62 Ohms	—	—	500
RT095-046-046	.374 (9.5 mm)	.181 (4.6 mm)	.180 (4.57mm)	—	47 Ohms	—	500
RT095-048-048	.374 (9.5 mm)	.189 (4.8 mm)	.189 (4.8 mm)	46 Ohms	—	33 Ohms	500
RT095-050-050	.374 (9.5 mm)	.197 (5.0 mm)	.197 (5.0 mm)	—	43 Ohms	55 Ohms	1000
RT100-060-040	.394 (10.0 mm)	.236 (6.0 mm)	.157 (4.0 mm)	—	46 Ohms	—	1000
RT100-060-050	.394 (10.0 mm)	.236 (6.0 mm)	.197 (5.0 mm)	—	35 Ohms	—	TBD
RT100-062-062	.394 (10.0 mm)	.242 (6.15mm)	.244 (6.2 mm)	28 Ohms	—	—	500
RT100-070-050	.394 (10.0 mm)	.276 (7.0 mm)	.197 (5.0 mm)	44 Ohms	—	—	500
RT100-070-075	.394 (10.0 mm)	.276 (7.0 mm)	.295 (7.5 mm)	39 Ohms	—	—	500
RT110-050-090	.433 (11.0 mm)	.197 (5.0 mm)	.354 (9.0 mm)	99 Ohms	—	—	200
RT120-060-040	.472 (12.0 mm)	.236 (6.0 mm)	.157 (4.0 mm)	45 Ohms	—	34 Ohms	500
RT120-060-060	.472 (12.0 mm)	.236 (6.0 mm)	.236 (6.0 mm)	49 Ohms	—	—	500
RT120-060-080	.472 (12.0 mm)	.236 (6.0 mm)	.315 (8.0 mm)	—	85 Ohms	—	500
RT120-070-055	.472 (12.0 mm)	.276 (7.0 mm)	.217 (5.5 mm)	—	44 Ohms	—	500
RT120-070-060	.472 (12.0 mm)	.276 (7.0 mm)	.236 (6.0 mm)	—	—	46 Ohms	500
RT120-070-080	.472 (12.0 mm)	.276 (7.0 mm)	.315 (8.0 mm)	55 Ohms	—	—	500
RT125-080-064	.492 (12.5 mm)	.315 (8.0 mm)	.250 (6.35mm)	—	46 Ohms	—	500
RT125-080-120	.492 (12.5 mm)	.315 (8.0 mm)	.472 (12.0 mm)	—	—	—	200
RT130-070-055	.512 (13.0 mm)	.276 (7.0 mm)	.217 (5.5 mm)	—	52 Ohms	—	300
RT130-070-070	.512 (13.0 mm)	.276 (7.0 mm)	.276 (7.0 mm)	44 Ohms	—	—	200
RT140-080-050	.551 (14.0 mm)	.315 (8.0 mm)	.197 (5.0 mm)	—	48 Ohms	—	500
RT140-080-070	.551 (14.0 mm)	.315 (8.0 mm)	.276 (7.0 mm)	55 Ohms	—	—	500
RT142-064-102	.559 (14.2 mm)	.250 (6.35mm)	.400 (10.16mm)	—	—	—	TBD
RT142-070-150	.559 (14.2 mm)	.276 (7.0 mm)	.591 (15.0 mm)	—	—	80 Ohms	200
RT142-080-120	.559 (14.2 mm)	.315 (8.0 mm)	.472 (12.0 mm)	—	—	—	200
RT145-103-080	.571 (14.5 mm)	.406 (10.3 mm)	.315 (8.0 mm)	64 Ohms	—	—	200
RT150-105-120	.591 (15.0 mm)	.413 (10.5 mm)	.472 (12.0 mm)	60 Ohms	—	—	200
RT158-079-142	.625 (15.88mm)	.310 (7.87mm)	.562 (14.27mm)	—	131 Ohms	—	100
RT160-080-160	.630 (16.0 mm)	.315 (8.0 mm)	.630 (16.0 mm)	119 Ohms	—	—	TBD
RT160-090-120	.630 (16.0 mm)	.472 (12.0 mm)	.315 (8.0 mm)	45 Ohms	—	—	100

*Impedance figures are typical values.*

# ELECTRONIC COMPONENT ACCESSORIES

## RT Series (cont.) Toroidal Cores

### PART NUMBER CODE EXAMPLE

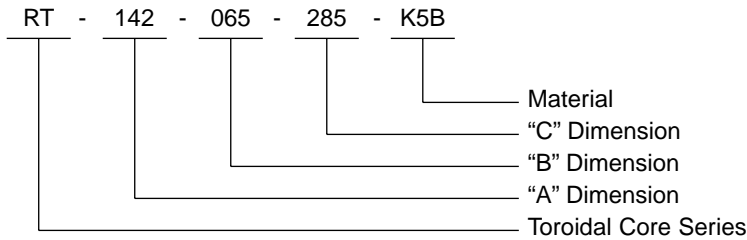

All dimensions shown are for the standard products available. However, other variations can be made to individual customer specification where required.

Material: Core Materials: K5B, A5, A6 • Color: Gray

Part Number	Dimensions			Impedance ( $\Omega$ at 100 Mhz)			Standard Pack per Bag
	"A"	"B"	"C"	K5B	A5	A6	
RT160-120-080	.630 (16.0 mm)	.354 (9.0 mm)	.472 (12.0 mm)	84 Ohms	—	—	200
RT160-120-150	.630 (16.0 mm)	.472 (12.0 mm)	.591 (15.0 mm)	60 Ohms	—	—	100
RT165-082-130	.650 (16.5 mm)	.323 (8.2 mm)	.512 (13.0 mm)	105 Ohms	—	—	120
RT165-082-160	.650 (16.5 mm)	.323 (8.2 mm)	.630 (16.0 mm)	110 Ohms	—	—	120
RT165-092-075	.650 (16.5 mm)	.362 (9.2 mm)	.295 (7.5 mm)	70 Ohms	—	—	200
RT175-080-100	.689 (17.5 mm)	.315 (8.0 mm)	.394 (10.0 mm)	—	—	—	TBD
RT175-095-064	.689 (17.5 mm)	.374 (9.5 mm)	.250 (6.35mm)	—	51 Ohms	—	200
RT175-095-127	.689 (17.5 mm)	.374 (9.5 mm)	.500 (12.7 mm)	95 Ohms	—	—	100
RT175-095-150	.689 (17.5 mm)	.374 (9.5 mm)	.591 (15.0 mm)	111 Ohms	—	—	100
RT175-107-080	.689 (17.5 mm)	.421 (10.7 mm)	.315 (8.0 mm)	58 Ohms	—	—	200
RT180-100-060	.709 (18.0 mm)	.394 (10.0 mm)	.236 (6.0 mm)	48 Ohms	—	45 Ohms	200
RT180-100-100	.709 (18.0 mm)	.394 (10.0 mm)	.394 (10.0 mm)	70 Ohms	—	—	100
RT187-102-102	.735 (18.67mm)	.400 (10.16mm)	.400 (10.16mm)	—	—	—	100
RT187-102-143	.735 (18.67mm)	.400 (10.16mm)	.562 (14.27mm)	109 Ohms	—	—	150
RT187-102-170	.735 (18.67mm)	.400 (10.16mm)	.670 (17.02mm)	—	123 Ohms	—	TBD
RT187-102-185	.735 (18.67mm)	.400 (10.16mm)	.729 (18.52mm)	—	—	—	TBD
RT190-120-080	.748 (19.0 mm)	.472 (12.0 mm)	.315 (8.0 mm)	140 Ohms	—	—	200
RT190-120-100	.748 (19.0 mm)	.472 (12.0 mm)	.394 (10.0 mm)	—	—	—	TBD
RT205-102-050	.807 (20.5 mm)	.402 (10.2 mm)	.197 (5.0 mm)	63 Ohms	—	—	140
RT205-102-100	.807 (20.5 mm)	.402 (10.2 mm)	.394 (10.0 mm)	100 Ohms	—	—	800
RT212-127-060	.835 (21.2 mm)	.500 (12.7 mm)	.236 (6.0 mm)	51 Ohms	—	—	200
RT220-135-064	.866 (22.0 mm)	.531 (13.5 mm)	.250 (6.35mm)	50 Ohms	—	—	200
RT220-135-080	.866 (22.0 mm)	.531 (13.5 mm)	.315 (8.0 mm)	—	70 Ohms	—	100
RT220-140-100	.866 (22.0 mm)	.551 (14.0 mm)	.394 (10.0 mm)	92 Ohms	—	—	100
RT221-137-064	.866 (22.0 mm)	.540 (13.72mm)	.250 (6.35mm)	—	—	—	TBD
RT221-137-127	.870 (22.1 mm)	.540 (13.72mm)	.500 (12.7 mm)	—	80 Ohms	—	100
RT225-138-127	.886 (22.5 mm)	.543 (13.8 mm)	.500 (12.7 mm)	71 Ohms	—	—	TBD
RT230-135-064	.906 (23.0 mm)	.531 (13.5 mm)	.250 (6.35mm)	—	48 Ohms	—	200
RT236-150-114	.929 (23.6 mm)	.591 (15.0 mm)	.449 (11.4 mm)	82 Ohms	—	—	100
RT250-150-080	.984 (25.0 mm)	.591 (15.0 mm)	.315 (8.0 mm)	77 Ohms	—	—	TBD
RT250-150-100	.984 (25.0 mm)	.591 (15.0 mm)	.394 (10.0 mm)	—	—	—	600
RT250-150-120	.984 (25.0 mm)	.591 (15.0 mm)	.472 (12.0 mm)	—	89 Ohms	82 Ohms	600
RT254-127-064	1.000 (25.4 mm)	.500 (12.7 mm)	.250 (6.35mm)	—	78 Ohms	—	100
RT260-130-127	1.024 (26.0 mm)	.512 (13.0 mm)	.500 (12.7 mm)	—	120 Ohms	—	600
RT280-160-075	1.102 (28.0 mm)	.630 (16.0 mm)	.295 (7.5 mm)	60 Ohms	—	—	100
RT280-160-130	1.102 (28.0 mm)	.630 (16.0 mm)	.512 (13.0 mm)	108 Ohms	—	—	320
RT280-160-170	1.102 (28.0 mm)	.630 (16.0 mm)	.669 (17.0 mm)	—	113 Ohms	—	600
RT310-190-070	1.220 (31.0 mm)	.748 (19.0 mm)	.276 (7.0 mm)	—	50 Ohms	—	100
RT310-190-080	1.220 (31.0 mm)	.748 (19.0 mm)	.315 (8.0 mm)	—	52 Ohms	—	440
RT310-190-150	1.220 (31.0 mm)	.748 (19.0 mm)	.591 (15.0 mm)	—	—	—	TBD
RT310-190-160	1.220 (31.0 mm)	.748 (19.0 mm)	.630 (16.0 mm)	—	104 Ohms	—	320
RT310-190-222	1.220 (31.0 mm)	.748 (19.0 mm)	.875 (22.22mm)	—	141 Ohms	—	192
RT406-274-150	1.598 (40.6 mm)	1.079 (27.4 mm)	.591 (15.0 mm)	90 Ohms	—	—	144
RT614-360-128	2.417 (61.4 mm)	1.417 (36.0 mm)	.504 (12.8 mm)	—	117 Ohms	—	80

Impedance figures are typical values.

# ELECTRONIC COMPONENT ACCESSORIES

## RT Series (cont.)

Toroidal Cores

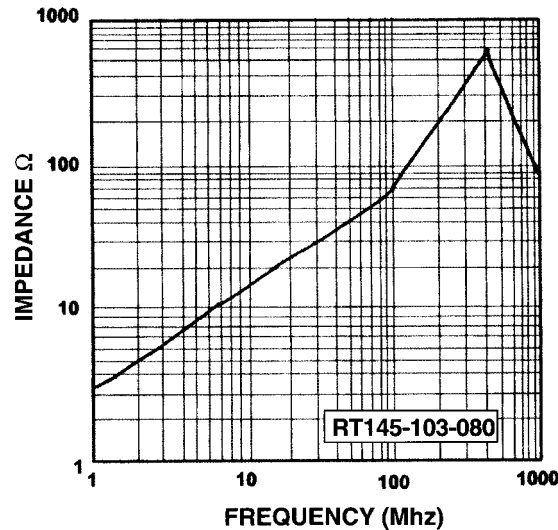
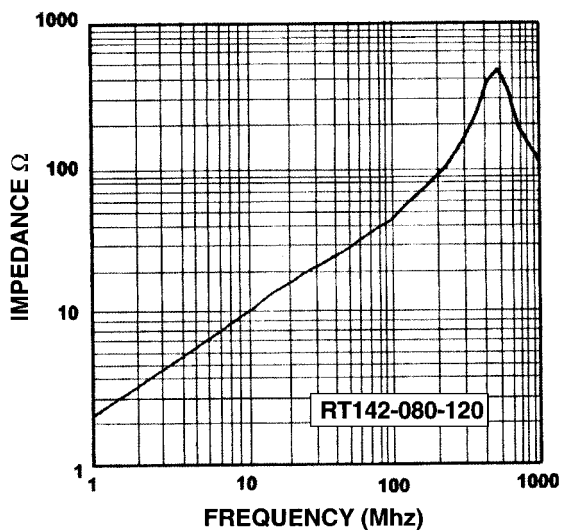
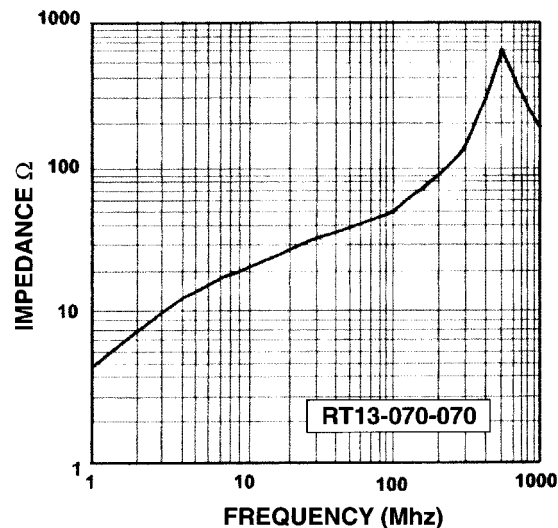
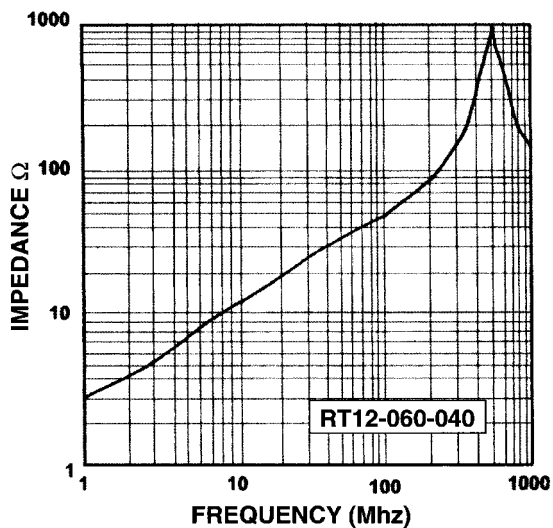
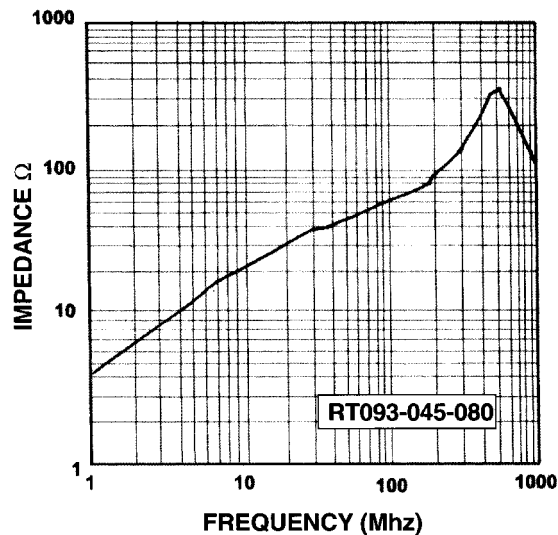
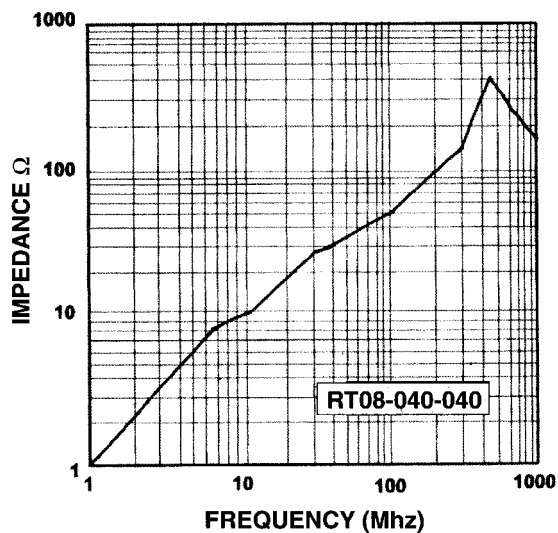

G

# ELECTRONIC COMPONENT ACCESSORIES

## RT Series (cont.)

Toroidal Cores

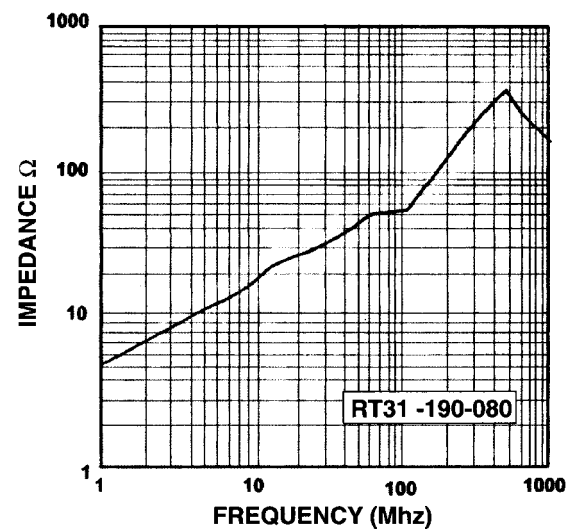
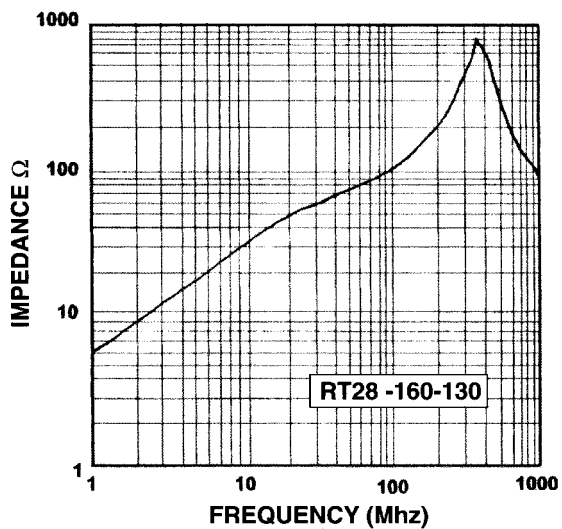
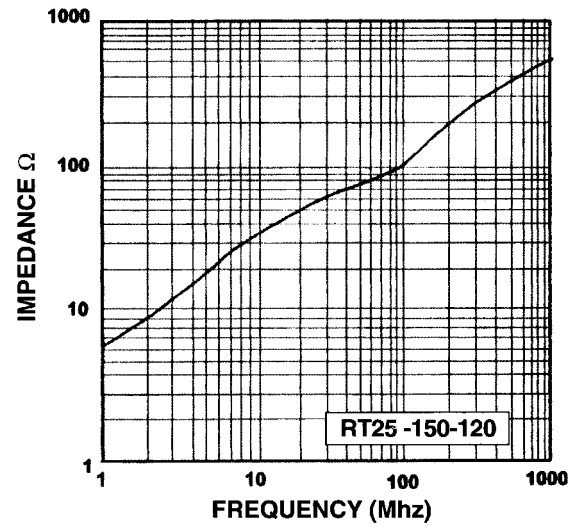
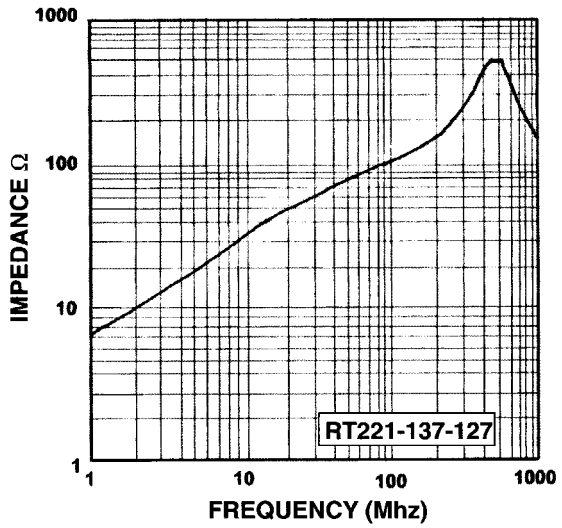
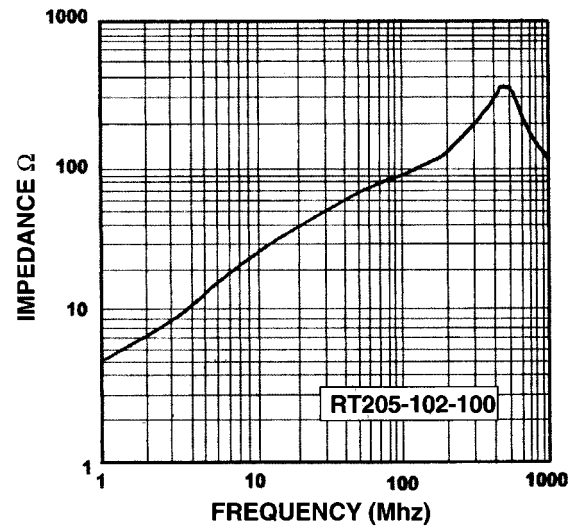
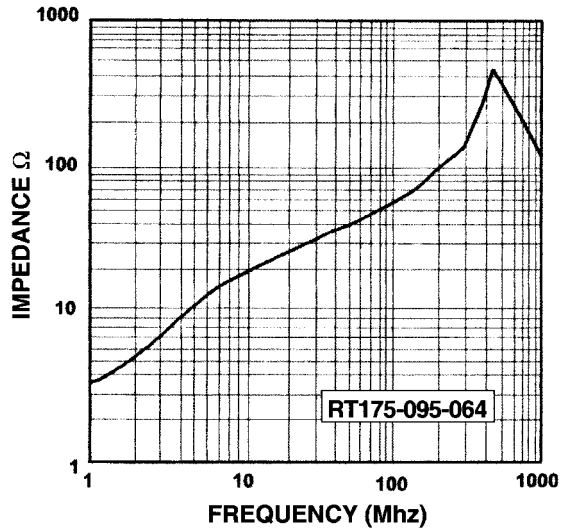

G