

# Technical data sheet

## Locknut, metric thread

Item no. 2091631



Locknuts DIN 46319 with metric thread IEC 423.

\* Prices according to DEL notation.



<b>CuZn</b>	Brass
<b>N</b>	Nickel-plated

### Master data

Item no.	2091631
Type	169 MS M25
Description 1	Locknut
Dimension	M25
Material	Brass
Material symbol	CuZn
Surface	Nickel-plated
Surface symbol	N
Smallest sales unit (VG)	100,00 Piece
Weight	0,88 kg/100 pc.

### Technical data

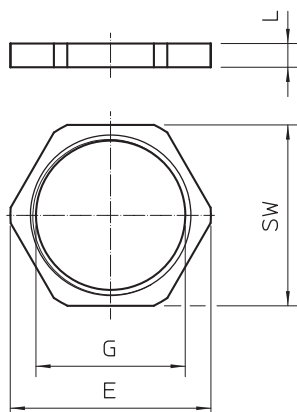

Dimension E	33,20 mm
Dimension L	3,50 mm
WAF	30,00 mm
Thread type	Metric
Thread	M25 x 1,5
Nominal thread size metric/PG	25,00
Fibre-glass reinforced	<input type="checkbox"/>
Halogen-free	<input type="checkbox"/>
Impact-resistant	<input type="checkbox"/>