

REV.	MODIFICATION.	DATE	DRN
01	NEW DRAWING	18/10/04	NJB
02	ECN2005-057	27/04/05	OW
03	ECN2005-069	26/05/05	OW
04	ECN06-227	03/10/06	NJB

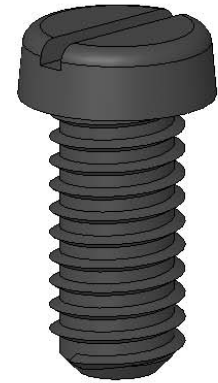
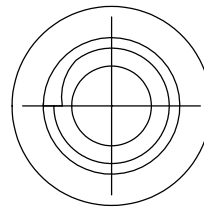
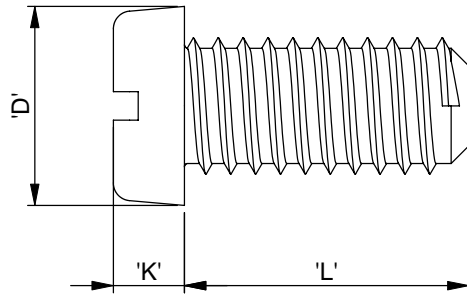

NOTES:

- 1a) Metric primary units: mm.
- b) Imperial secondary units: [Inches].

NSE-1580-M6-L	5.0 (.197)	6.0 (.236)	8.0 (.315)	10.0 (.394)	12.0 (.473)	16.0 (.630)	20.0 (.788)	25.0 (.985)	30.0 (1.182)	40.0 (1.575)	50.0 (1.969)	12.0 [.473]	3.6 [.141]
NSE-1580-M5-L	6.0 (.236)	8.0 (.315)	10.0 (.394)	12.0 (.473)	16.0 (.630)	20.0 (.788)	25.0 (.985)	30.0 (1.182)	40.0 (1.575)			9.5 [.374]	3.0 [.118]
NSE-1580-M4-L	6.0 (.236)	8.0 (.315)	10.0 (.394)	12.0 (.473)	16.0 (.630)	20.0 (.788)	25.0 (.985)	30.0 (1.182)	40.0 (1.575)			8.0 [.315]	2.4 [.094]
NSE-1580-M3-L	4.0 (.158)	5.0 (.197)	6.0 (.236)	8.0 (.315)	10.0 (.394)	12.0 (.473)	16.0 (.630)	20.0 (.788)	25.0 (.985)	30.0 (1.182)		5.6 [.220]	1.8 [.070]
NSE-1580-M2.5-L	6.0 (.236)	8.0 (.315)	10.0 (.394)	12.0 (.473)	15.0 (.591)	20.0 (.788)	25.0 (.985)					5.0 [.197]	1.5 [.059]
NSE-1580-M2-L	4.0 (.158)	5.0 (.197)	6.0 (.236)	8.0 (.315)	10.0 (.394)	12.0 (.473)	16.0 (.630)	20.0 (.788)	25.0 (.985)			4.0 [.158]	1.3 [.051]
PART REF:	L											D	K

INFORMATION CONTAINED IN THIS DOCUMENT IS CONFIDENTIAL TO RICHCO INTERNATIONAL Co. Ltd. AND MAY NOT BE DISCLOSED OR REPRODUCED IN WHOLE OR PART WITHOUT THEIR WRITTEN CONSENT



GENERAL TOLERANCES ± 0.25 [0.010]
ARE FOR REFERENCE UNLESS OTHERWISE
1 DECIMAL PLACE \pm
2 DECIMAL PLACES \pm
ANGULAR $\pm 1^\circ$

MATERIAL: NYLON 6/6 (RMS-179)				COLOUR: NATURAL	
TITLE: METRIC SCREW (DIN EN ISO 1580)				PART No: NSE-1580-MX-L	
DRG No: 04-115		NPR REF:			
DRN NJB		DATE 18/10/04		SCALE NTS	
CHKD I.C		DATE 18/10/04		SHEET No 1 OF 1	