

Current Rating: 4A AC,DC  
 Voltage Rating: 250V AC,DC  
 Temperature Range: -25°C ~ +85°C  
 Contact Resistance: 10mΩ Max  
 Insulation Resistance: 1000MΩ Min  
 Withstanding Voltage: 1000V AC/minute

PART NO.	Dimensions		PART NO.	Dimensions	
	A	B		A	B
02P	2.54	5.68	12P	27.94	31.08
03P	5.08	8.22	13P	30.48	33.62
04P	7.62	10.76	14P	33.02	36.16
05P	10.16	13.30	15P	35.56	38.70
06P	12.70	15.84	16P	38.10	41.24
07P	15.24	18.38	17P	40.64	43.78
08P	17.78	20.92	18P	43.18	46.32
09P	20.32	23.46	19P	45.72	48.86
10P	22.86	26.00	20P	48.26	51.40
11P	25.40	28.54			

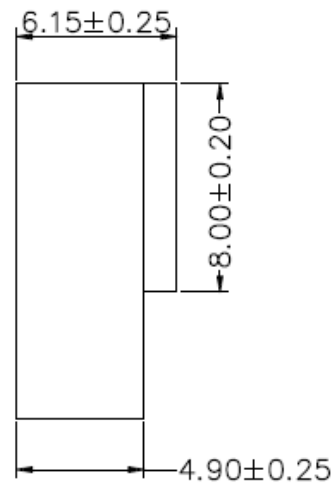
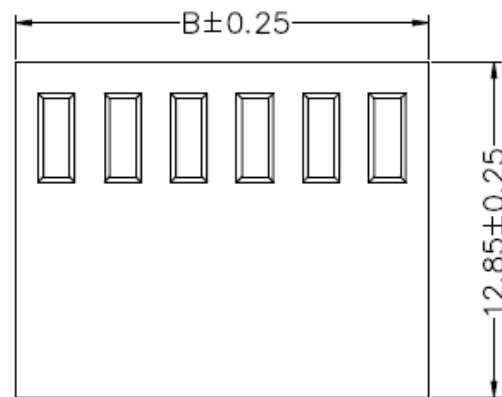

TYPE 1

				UNIT			SCALE		SHEET		TITLE:	
				mm			1 : 1		1 of 1		2.54mm PITCH HOUSING	
				DRAWN BY		APPROVED BY		DRAW NO. : <b>NS25-GXX</b> REV. <b>A1</b>				
				王亮		張子波						
				2013.07.10		2013.07.10						
				GENERAL TOLERANCE								
A1	PRELIMINARY RELEASE	2022.05.30	周銳權	X.X±0.25	ANGLE±							
A0	NEW RELEASE	2013.07.10	王亮	X.XX±0.15	⊕							
REV.	DESCRIPTION	DATE	NAME	X.XXX±0.05	⊕							