

LOW PROFILE SURFACE MOUNT COIN CELL HOLDERS

AVAILABLE ON TAPE AND REEL

- Surface mount coin cell holders designed for reflow or wave soldering.
- Battery can be installed and replaced with ease.
- Solder tails are viewable for quick inspection of the solder joint.
- All holders are available on tape and reel for pick and place applications.
- All conductive polystyrene carrier tape meets ANSI/EIA - 481 standard.

1/3N CELL

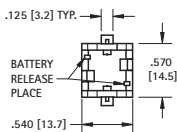

MATERIAL:

Contacts: .012 (.30) Phosphor Bronze, Gold Plate (Flash)
Base: High Temperature Nylon 46, UL94V-0

CAT. NO. 498 (Bulk)

CAT. NO. 498TR (Tape & Reel)

Tape & Reel Spec's: 44mm wide; 24mm pitch; 13 inch reel (150 pieces per reel)

Pad Layout

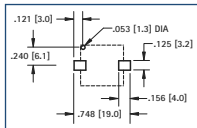

TOP LOADING

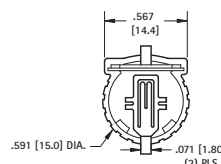

MATERIAL:

Contacts: .008 (.20) Phosphor Bronze, Gold Plate (Flash)
Base: Glass filled PPS, UL 94V-0

CAT. NO. 1056 (Bulk)

CAT. NO. 1056TR (Tape & Reel)

Tape & Reel Spec's: 32mm wide; 20mm pitch; 13 inch reel (500 pieces per reel)

Pad Layout

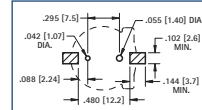

2025 / 2032 CELL

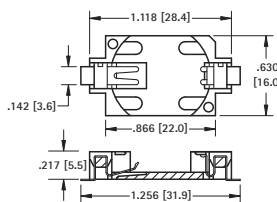

MATERIAL:

Contacts: .006 (.15) Phosphor Bronze, Gold Plate (Flash)
Base: Glass Filled LCP, UL 94V-0

CAT. NO. 1060 (Bulk)

CAT. NO. 1060TR (Tape & Reel)

Tape & Reel Spec's: 44mm wide; 24mm pitch; 13 inch reel (500 pieces per reel)

Pad Layout

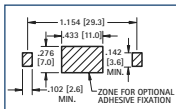

2450 CELL

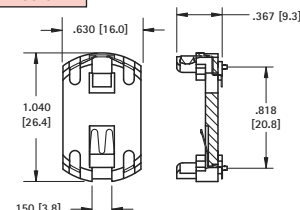

MATERIAL:

Contacts: .008 (.20) Phosphor Bronze, Gold Plate (Flash)
Base: High Temperature Nylon 46, UL94V-0

CAT. NO. 1054 (Bulk)

CAT. NO. 1054TR (Tape & Reel)

Tape & Reel Spec's: 44mm wide; 24mm pitch; 13 inch reel (200 pieces per reel)

Pad Layout

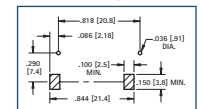

SIDE LOADING

20mm & 23mm CELLS

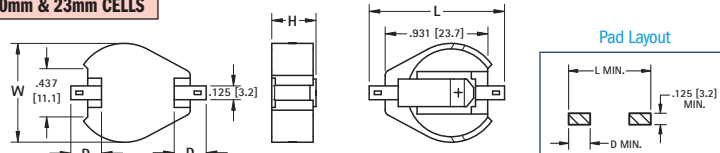

MATERIAL: **Contacts:** .015 (.38) Steel **Base:** High Temperature, Nylon 46, UL 94V-0
Tape & Reel Spec's: 44mm wide; 32mm pitch; 13 inch reel (200 pieces per reel)

SMALL PAD PATTERN		Contacts: Tin Nickel-Plate							CELL	BATTERY
CAT. NO. BULK	CAT. NO. TAPE	CELLS	H	W	L	D				
1061	1061TR	1	.290 (7.4)	.896 (22.8)	1.015 (25.8)	.156 (4.0)		20mm	2016*, 2020, 2025, 2032	
1062	1062TR	2	.391 (9.9)	.896 (22.8)	1.015 (25.8)	.156 (4.0)		23mm	2320, 2325, 2330	
1071	1071TR	1	.290 (7.4)	1.000 (25.4)	1.015 (25.8)	.156 (4.0)				

*Cat. No. 1061 (1 or 2 cells); Cat. No. 1062 (3 cells)

LARGE PAD PATTERN		Contacts: Tin-Nickel Plate							CELL	BATTERY
CAT. NO. BULK	CAT. NO. TAPE	CELLS	H	W	L	D				
1063	1063TR	1	.290 (7.4)	.896 (22.8)	1.250 (31.8)	.278 (7.1)		20mm	2016*, 2020, 2025, 2032	
1064	1064TR	2	.391 (9.9)	.896 (22.8)	1.250 (31.8)	.278 (7.1)		23mm	2320, 2325, 2330	
1073	1073TR	1	.290 (7.4)	1.000 (25.4)	1.250 (31.8)	.278 (7.1)				

*Cat. No. 1063 (1 or 2 cells); Cat. No. 1064 (3 cells)

		Contacts: Gold Plate (Flash)							CELL	BATTERY
CAT. NO. BULK	CAT. NO. TAPE	CELLS	H	W	L	D				
1081	1081TR	1	.290 (7.4)	.896 (22.8)	1.015 (25.8)	.156 (4.0)		20mm	2016*, 2020, 2025, 2032	
1082	1082TR	2	.391 (9.9)	.896 (22.8)	1.015 (25.8)	.156 (4.0)		23mm	2320, 2325, 2330	
1091	1091TR	1	.290 (7.4)	1.000 (25.4)	1.015 (25.8)	.156 (4.0)				

*Cat. No. 1081 (1 or 2 cells); Cat. No. 1082 (3 cells)

		Contacts: Gold Plate (Flash)							CELL	BATTERY
CAT. NO. BULK	CAT. NO. TAPE	CELLS	H	W	L	D				
1093	1093TR	1	.290 (7.4)	.896 (22.8)	1.250 (31.8)	.278 (7.1)		20mm	2016*, 2020, 2025, 2032	
1094	1094TR	2	.391 (9.9)	.896 (22.8)	1.250 (31.8)	.278 (7.1)		23mm	2320, 2325, 2330	
1083	1083TR	1	.290 (7.4)	1.000 (25.4)	1.250 (31.8)	.278 (7.1)				

*Cat. No. 1093 (1 or 2 cells); Cat. No. 1094 (3 cells)

INSULATED RETAINERS

20mm CELLS



- Ideal for 6 volt or 3 volt applications.
- Two coin cell batteries can be installed in series.
- Plastic insulator prevents shorting of battery, within the holder, if installed improperly.
- Low profile.
- Battery release ports for easy battery replacement.

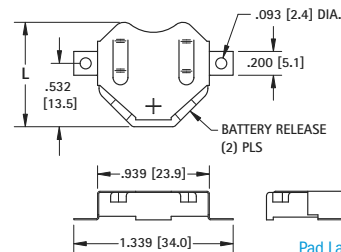

Pad Layout

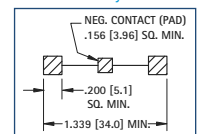

MATERIAL: **Contacts:** .010 (.25) Phosphor Bronze
Insulator: High Temperature, Nylon 46, UL 94V-0
Tape & Reel Spec's: 44mm wide; 28mm pitch; 13 inch reel
3020TR, 3070TR 500 pieces per reel
3022TR, 3072TR 250 pieces per reel

TIN-NICKEL PLATE		MATTE TIN PLATE		BATTERY REFERENCE	
CAT. NO. BULK	CAT. NO. TAPE	CAT. NO. BULK	CAT. NO. TAPE	L	H
3020	3020TR	3070	3070TR	.890 (22.6)	.156 (4.0)
3022	3022TR	3072	3072TR	.877 (22.3)	.240 (6.1)
				6 volt (2) Cells	3 volt (1) Cell
				2012, 2016	2020, 2025
				2020, 2025	2032