

SURFACE & THRU HOLE MOUNT COMPACT CONTACTS

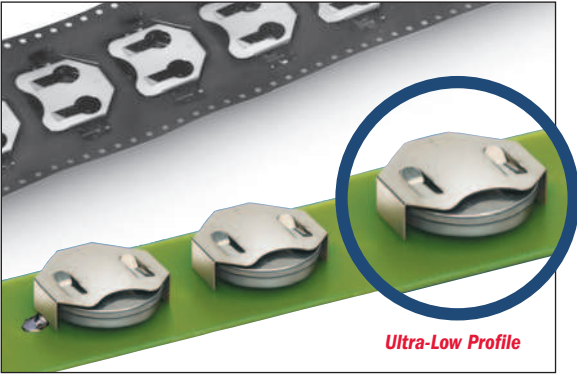

AVAILABLE ON TAPE AND REEL

Economical and reliable retainer contacts are designed for quick and easy battery installation and replacement. Perfect for memory back-up applications. Surface and Thru Hole mount retainer contacts are available for 6.8mm to 24mm lithium coin cell batteries.

- Low profile for densely packed PCBs
- Retains cell securely, withstands shock & vibrations
- Reliable dual spring contacts assure low contact resistance
- Polarity clearly marked (+)
- Stable thru mount legs for increased strength
- Balanced & lightweight for reliable pick-up & placement
- Compatible with vacuum and mechanical pick & place assembly systems
- "Flow-Hole" SMT solder tail design for increased joint strength
- Viewable solder tails assures reliable joint inspection
- All conductive polystyrene carrier tape meets ANSI/EIA- 481 standard

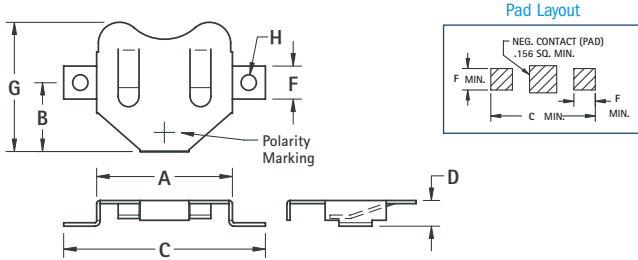

DWG. 1 - SURFACE MOUNT (SMT) MATERIAL: .010 (.25) thick Phosphor Bronze, Tin Nickel Plate

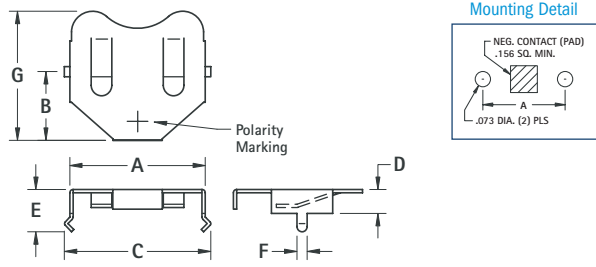

DWG. 2 - THRU HOLE MOUNT (THM) MATERIAL: .010 (.25) thick Phosphor Bronze, Tin Nickel Plate

CAT. NO.	ON TAPE & REEL	DWG. NO.	MTG. TYPE	A	B	C	D	E	F	G	H DIA.	CELL DIA.	BATTERY REFERENCE	TAPE & REEL SPEC'S
2996	2996TR	1	SMT	.520 (13.2)	.265 (6.7)	.700 (17.8)	.235 (6.0)	—	.125 (3.2)	.500 (12.7)	NO HOLE	11.6mm	SR44, LR44, 357, MS76, PX76A, G-13, 303, V313	32mm wide; 16mm pitch; 13 inch reel (600 pieces per reel)
2997	—	2	THM	.520 (13.2)	.265 (6.7)	.585 (14.9)	.238 (6.1)	.328 (8.3)	.062 (1.6)	.500 (12.7)	—	—	—	—
3000	3000TR	1	SMT	.520 (13.2)	.265 (6.7)	.745 (18.9)	.125 (3.2)	—	.125 (3.2)	.500 (12.7)	.047 (1.2)	12mm	BR1216, CR1216, BR1220, CL1220, CR1220, BR1225	32mm wide; 16mm pitch; 13 inch reel (1000 pieces per reel)
3001	—	2	THM	.520 (13.2)	.265 (6.7)	.585 (14.9)	.118 (3.0)	.210 (5.3)	.062 (1.6)	.500 (12.7)	—	—	—	—
3012	3012TR	1	SMT	.664 (16.9)	.344 (8.7)	.914 (23.2)	.156 (4.0)	—	.125 (3.2)	.594 (15.1)	.047 (1.2)	16mm	BR1616, CR1612, CR1616, CR1620, CR1632	44mm wide; 24mm pitch; 13 inch reel (600 pieces per reel)
3013	—	2	THM	.664 (16.9)	.344 (8.7)	.723 (18.4)	.145 (3.7)	.265 (6.7)	.062 (1.6)	.594 (15.1)	—	—	—	—
3002	3002TR	1	SMT	.831 (21.1)	.416 (10.6)	1.210 (30.7)	.156 (4.0)	—	.200 (5.1)	.782 (19.9)	.093 (2.4)	20mm	BR2016, CR2016, DL2016, BR2020, CL2020, BR2025, CR2025, DL2025, DR2032, CR2032, DL2032	44mm wide; 24mm pitch; 13 inch reel (500 pieces per reel)
3003	—	2	THM	.831 (21.1)	.416 (10.6)	.890 (22.6)	.145 (3.7)	.265 (6.7)	.062 (1.6)	.782 (19.9)	—	—	—	—
3004	3004TR	1	SMT	.939 (23.9)	.475 (12.1)	1.339 (34.0)	.145 (3.7)	—	.200 (5.1)	.939 (23.9)	.093 (2.4)	23mm	BR2320, CL2330, CR2320, BR2325, CR2325, DL2325	56mm wide; 32mm pitch; 13 inch reel (400 pieces per reel)
3005	—	2	THM	.939 (23.9)	.475 (12.1)	1.004 (25.5)	.145 (3.7)	.256 (6.5)	.062 (1.6)	.939 (23.9)	—	—	—	—
3010	3010TR	1	SMT	.939 (23.9)	.475 (12.1)	1.339 (34.0)	.240 (6.1)	—	.200 (5.1)	.819 (20.8)	.093 (2.4)	23mm	CR2354, DL2354	56mm wide; 32mm pitch; 13 inch reel (200 pieces per reel)
3011	—	2	THM	.939 (23.9)	.475 (12.1)	1.004 (25.5)	.240 (6.1)	.351 (8.9)	.062 (1.6)	.819 (20.8)	—	—	—	—
3006	3006TR	1	SMT	1.000 (25.4)	.506 (12.9)	1.400 (35.6)	.156 (4.0)	—	.200 (5.1)	.918 (23.3)	.093 (2.4)	24mm	CR2430, DL2430	56mm wide; 32mm pitch; 13 inch reel (400 pieces per reel)
3007	—	2	THM	1.000 (25.4)	.506 (12.9)	1.065 (27.1)	.145 (3.7)	.265 (6.7)	.062 (1.6)	.918 (23.3)	—	—	—	—
3008	3008TR	1	SMT	1.000 (25.4)	.506 (12.9)	1.400 (35.6)	.230 (5.8)	—	.200 (5.1)	.890 (22.6)	.093 (2.4)	24mm	CR2450, DL2450	56mm wide; 32mm pitch; 13 inch reel (200 pieces per reel)
3009	—	2	THM	1.000 (25.4)	.506 (12.9)	1.059 (26.9)	.230 (5.8)	.350 (8.9)	.062 (1.6)	.890 (22.6)	—	—	—	—

For 6.8mm BUTTON CELLS

AVAILABLE ON TAPE AND REEL

MATERIAL: .010 (.25) thick Phosphor Bronze, Tin Nickel Plate

Tape & Reel Spec's: 24mm wide; 12mm pitch; 13 inch reel (1250 pieces per reel)

CAT. NO. 2998 (Bulk)

CAT. NO. 2998TR (Tape and Reel)

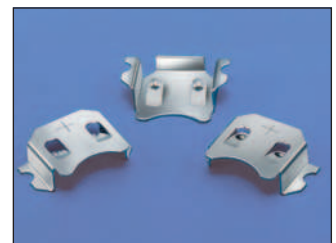
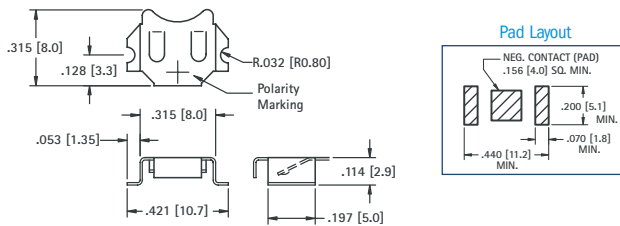

For use with Batteries MC621, V364 and SC621

NEGATIVE BATTERY CONTACTS

- Economical
- Space saving
- Ideal for self-contained battery compartments
- Contact us for modifications and custom design

THRU HOLE MOUNT

• Snap-In

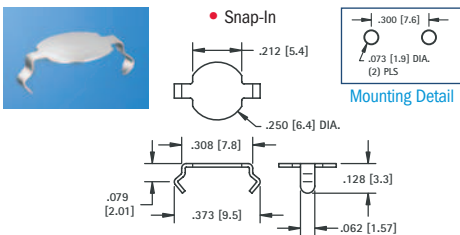

CAT. NO. 2990

MATERIAL: .008 (.20) thick Phosphor Bronze, Tin Nickel Plate

SURFACE MOUNT



MATERIAL: .008 (.20) thick Brass, Tin Nickel Plate

Tape & Reel Spec's: 16mm wide; 8mm pitch; 7 inch reel (1500 pieces per reel)

CAT. NO. 2991 (Bulk)

CAT. NO. 2991TR (Tape and Reel)

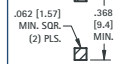
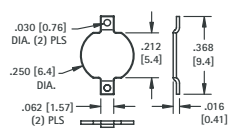

THRU HOLE MOUNT

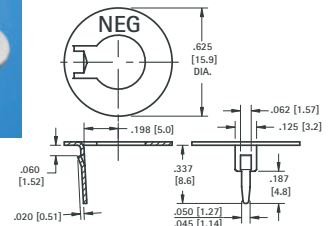

CAT. NO. 105-3

MATERIAL: .020 (.51) thick Spring Steel, Tin Nickel Plate