

Inductive proximity switches are contact-free sensors. They detect all conductive metals, regardless of whether they move or not. The achievable sensing range of the devices depends on the object material and its dimensions. The vibration-resistant sensors can be approached laterally or frontally. Inductive proximity switches are used for presence detection (e.g. goods carriers), positioning (e.g. dampers), counting (e.g. nuts /bolts), speed detection (e.g. for cog wheels), on conveyor systems (e.g. hose feedings) or distance measurements (e.g. press-in checking) of metallic objects.



TECHNICAL DATA

Devices for hose mounting	NO
Feeding technology	NO
Hygienic and wet area	NO
Metallic sensor surface	NO
Oil and lubricating coolants	NO
Ring-shaped sensors	NO
Rough ambient conditions	NO
Welding proof sensors	NO
Ambient temperature (min/max)	0°C / 150°C
Ambient temperatures > -25°C	NO
Cable length	2m
Compression-resistant	NO
Construction type housing	Cylinder, screw-thread
Core cross section	0.25mm ²
Degree of protection (IP)	IP50
High-pressure resistant sensors	NO
Increased ambient temperatures > 80°C	YES
Length of sensor	56mm
Material active area of sensor	Vectra®
Material housing	Metal
Material housing	Stainless steel 1.4305
Material independent sensors (factor 1)	NO
Material of cable sheath	Silicone
Mechanical mounting condition for sensor	Concise
Number of cores	3
Pitch thread	1mm
Sensors unaffected by atmospheric changes (temperature cycle)	NO
Teflon housing	NO
Thread length	48mm
Thread size metric (M..)	12
Cascadable	NO

TECHNICAL DATA

Connection to an amplifier	NO
Correction factor (aluminium)	0.3
Correction factor (brass)	0.4
Correction factor (copper)	0.2
Correction factor (stainless steel)	0.7
Correction factor (steel)	1
Distance measuring sensors	NO
Double sensing range	NO
Hysteresis	15%
Increased sensing range	NO
Max. output current	120mA
No load current	15mA
Norm trimming plate	12x12x1
Quadruple sensing range	NO
Rated control supply voltage U_s at DC (min/max)	10V / 35V
Relative repeat accuracy	3%
Residual ripple	10%
Response time	1ms
Reverse polarity protection	YES
Short-circuit-proof	YES
Standby delay	80ms
Suited for safety functions	NO
Supply voltage (min/max)	10V / 35V
Switching distance	3mm
Switching frequency	500Hz
Triple sensing range	NO
Type of electric connection	Cable
Type of switch function	Normally open contact
Type of switching output	PNP
Voltage drop	2V
Voltage type	DC
With LED indication	NO
With monitoring function downstream switching devices	NO
Areas inquiry	NO
End position inquiry hydraulic cylinder	NO
Welding areas	NO

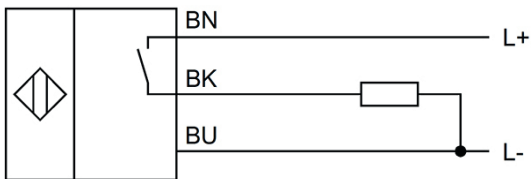
CONNECTION



Colors: BN (brown), BU (blue), BK (black)

Functions: BN = L+, BU = L-, BK = PNP NO

DIMENSIONAL DRAWING

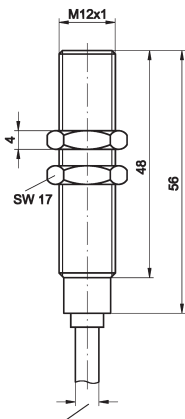

ADDITIONAL INFORMATION