



# GN 612.1

## Mounting blocks

Steel / Stainless Steel, for indexing plungers / cam action indexing plungers



---

### Specification

#### Types

- Type **A**: fixing holes parallell to plunger
- Type **B**: fixing holes vertical to plunger

Version in Steel

- blackened
- Grub screw [GN 913.3](#) with brass pad

Version in Stainless Steel AISI 303 **NI**

Grub screw [GN 913.5](#) with brass pad

---

### Information

Mounting blocks GN 612.1 broaden the mounting possibilities and are an added feature for the cam action indexing plungers GN 612 and cam action indexing plungers GN 712/ GN 712.1

To position the indexing pin of an indexing plunger or cam action indexing plunger, they can also hold [GN 412.2](#).

---

### Technical Information

- [Stainless Steel characteristics](#)
-

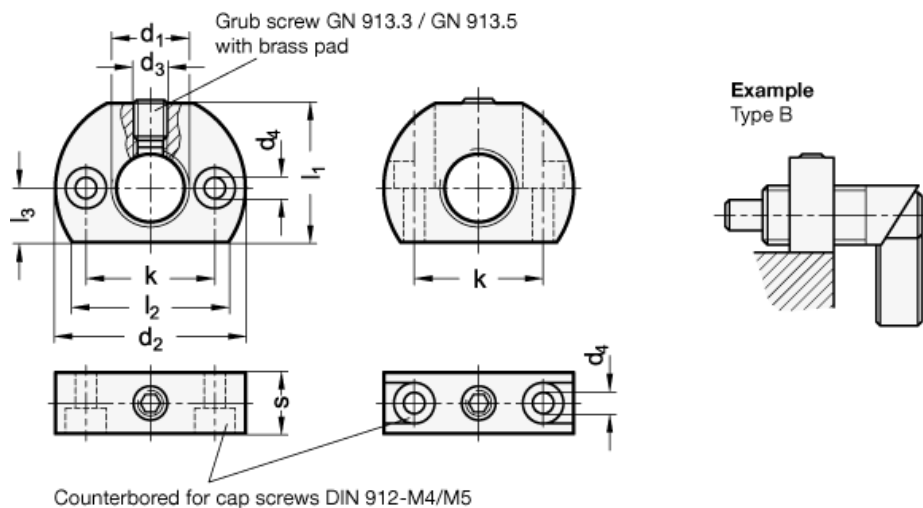

Description	d <sub>1</sub>	l <sub>2</sub>	d <sub>2</sub>	d <sub>3</sub>	k	s	l <sub>2</sub> ±0.5	l <sub>2</sub> ≈	l <sub>5</sub>	Weight
<b>GN 612.1-M12x1,5-A</b>	M 12 x 1.5	32	M 5	4.5	21	22	26.5	9	12	44
<b>GN 612.1-M16x1,5-A</b>	M 16 x 1.5	46	M 8	5.5	32	33	37	13	15	122
<b>GN 612.1-M20x1,5-A</b>	M 20 x 1.5	46	M 8	5.5	32	33	37	13	15	95
<b>GN 612.1-M12x1,5-B</b>	M 12 x 1.5	32	M 5	4.5	21	22	26.5	9	12	30
<b>GN 612.1-M16x1,5-B</b>	M 16 x 1.5	46	M 8	5.5	32	33	37	13	15	107
<b>GN 612.1-M20x1,5-B</b>	M 20 x 1.5	46	M 8	5.5	32	33	37	13	15	94

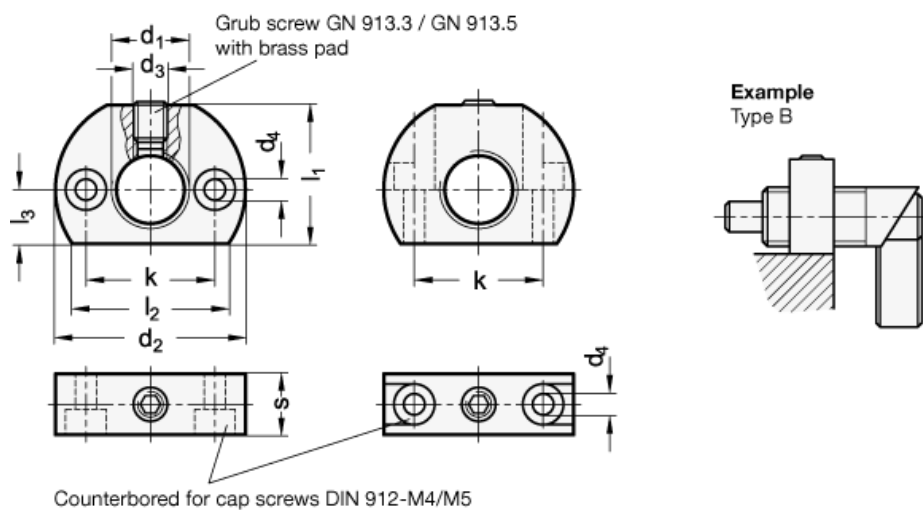

Description	d <sub>1</sub>	l <sub>2</sub>	d <sub>2</sub>	d <sub>3</sub>	k	s	l <sub>2</sub> ±0.5	l <sub>2</sub> ≈	l <sub>5</sub>	Weight
<b>GN 612.1-M12x1,5-A-NI</b>	M 12 x 1.5	32	M 5	4.5	21	22	26.5	9	12	43
<b>GN 612.1-M16x1,5-A-NI</b>	M 16 x 1.5	46	M 8	5.5	32	33	37	13	15	121
<b>GN 612.1-M20x1,5-A-NI</b>	M 20 x 1.5	46	M 8	5.5	32	33	37	13	15	110
<b>GN 612.1-M12x1,5-B-NI</b>	M 12 x 1.5	32	M 5	4.5	21	22	26.5	9	12	37
<b>GN 612.1-M16x1,5-B-NI</b>	M 16 x 1.5	46	M 8	5.5	32	33	37	13	15	56
<b>GN 612.1-M20x1,5-B-NI</b>	M 20 x 1.5	46	M 8	5.5	32	33	37	13	15	100