

## FIX-MADA

MATERIAL: NYLON 66(UL)  
 FLAME CLASS: 94V-2  
 COLOR: NATURAL  
 UNIT: mm

PART NO	A
FIX-MADA-2	2
FIX-MADA-3	3
FIX-MADA-3.5	3,5
FIX-MADA-4	4
FIX-MADA-5	5
FIX-MADA-6	6
FIX-MADA-7	7
FIX-MADA-8	8
FIX-MADA-8.5	8,5
FIX-MADA-9	9
FIX-MADA-10	10
FIX-MADA-11	11
FIX-MADA-12	12
FIX-MADA-12.7	12,7
FIX-MADA-14	14
FIX-MADA-16	16
FIX-MADA-18	18
FIX-MADA-20	20
FIX-MADA-22	22

MOUNTING HOLE  $\varnothing 2.5$   
 P.C.B THICKNESS 1.6

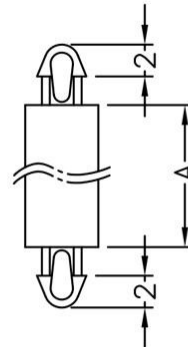

MOUNTING HOLE  $\varnothing 2.5$   
 P.C.B THICKNESS 1.6

