

Rubber buffers

Rubber and steel or stainless steel

STANDARD EXECUTIONS

- **DVA.5**: bushing with threaded blind hole and base plate in polished zinc-plated steel, vibration-damper body in natural rubber NR, black colour, hardness 40, 55, 70 Shore A ± 5 .
- **DVA.5-SST**: bushing with threaded blind hole and base plate in AISI 304 stainless steel, vibration-damper body in natural rubber NR, black colour, hardness 55 Shore A ± 5 .



FEATURES AND APPLICATIONS

The rubber buffers have been designed to damp vibrations, shocks and noises produced by moving bodies or non-balanced vibrating masses of equipment and machines which can cause:

- malfunctioning and reduction of the machine lifespan and/or of the adjacent ones;
- damage to health;
- noise.

Load diagrams for each single code are available on request. See Technical data and guidelines for the choice.

SPECIAL EXECUTIONS ON REQUEST

Natural rubber NR, hardness 40, 70 tolerance ± 5 Shore A for executions with AISI 304 stainless steel base.

* Complete the description with the desired hardness: 40, 55 or 70 tolerance ± 5 Shore A.

DVA.5 - 10 - 10 - M4 - 55
 D L d Shore A

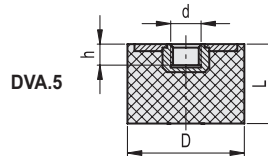

DVA.5

Description	D	L	d	h	△	Hardness 40 Shore A			Hardness 55 Shore A			Hardness 70 Shore A					
						Code	Max load [N]	Max deflection [mm]	Stiffness [N/mm]	Code	Max load [N]	Max deflection [mm]	Stiffness [N/mm]	Code	Max load [N]	Max deflection [mm]	Stiffness [N/mm]
DVA.5-8-8-M3*	8	8	M3	3	1	415691	34	2	17	413029	55	2	28	418391	141	2	71
DVA.5-8-13-M3*	8	13	M3	3	2	415693	33	3	10	413030	52	3	16	418393	133	3	41
DVA.5-10-10-M4*	10	10	M4	4	2	415701	54	3	21	413031	88	3	35	418401	217	3	87
DVA.5-10-15-M4*	10	15	M4	4	2	415703	69	4	18	413033	92	4	25	418403	175	4	47
DVA.5-15-15-M4*	15	15	M4	4	5	415711	141	4	38	413041	259	4	69	418411	384	4	102
DVA.5-15-20-M4*	15	20	M4	4	6	415721	134	5	27	413051	223	5	45	418421	590	5	118
DVA.5-20-15-M6*	20	15	M6	6	10	415731	289	4	77	413061	468	4	125	418431	704	4	188
DVA.5-20-20-M6*	20	20	M6	6	11	415741	258	5	52	413071	367	5	73	418441	809	5	162
DVA.5-20-25-M6*	20	25	M6	6	13	415751	250	6	40	413081	437	6	70	418451	750	6	120
DVA.5-20-30-M6*	20	30	M6	6	15	415756	285	7	38	413086	410	7	55	418456	615	7	82
DVA.5-25-15-M6*	25	15	M6	6	16	415761	485	4	129	413091	797	4	213	418461	1627	4	434
DVA.5-25-20-M6*	25	20	M6	6	20	415771	416	5	83	413101	581	5	116	418471	1382	5	276
DVA.5-25-25-M6*	25	25	M6	6	21	415776	510	6	82	413105	635	6	102	418476	1262	6	202
DVA.5-25-30-M6*	25	30	M6	6	21	415781	290	8	39	413106	591	8	79	418481	1186	8	158

* Complete the description with the desired hardness: 40, 55 or 70 tolerance ±5 Shore A.

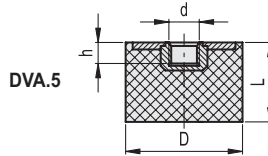

DVA.5

Description	D	L	d	h	△	Hardness 40 Shore A			Hardness 55 Shore A			Hardness 70 Shore A					
						Code	Max load [N]	Max deflection [mm]	Stiffness [N/mm]	Code	Max load [N]	Max deflection [mm]	Stiffness [N/mm]	Code	Max load [N]	Max deflection [mm]	Stiffness [N/mm]
DVA.5-30-15-M8-*	30	15	M8	8	23	415791	746	3	249	413111	1023	3	341	418491	2610	3	870
DVA.5-30-17-M8-*	30	17	M8	8	25	415801	772	3	257	413121	1275	3	425	418501	2447	3	816
DVA.5-30-20-M8-*	30	20	M8	8	27	415811	567	5	113	413141	1014	5	203	418511	1878	5	376
DVA.5-30-25-M6-*	30	25	M6	6	29	415816	495	6	79	413143	960	6	153	418516	1565	6	250
DVA.5-30-30-M8-*	30	30	M8	8	34	415821	601	8	80	413146	776	8	103	418521	1616	8	215
DVA.5-30-40-M8-*	30	40	M8	8	43	415823	550	10	55	413148	780	10	78	418523	1785	10	179
DVA.5-40-20-M8-*	40	20	M8	8	45	415831	1200	5	240	413151	2500	5	500	418531	4750	5	950
DVA.5-40-20-M10-*	40	20	M10	10	44	415857	1115	5	223	413176	1623	5	325	418557	5600	5	1120
DVA.5-40-30-M8-*	40	30	M8	8	65	415841	1140	8	152	413161	1480	8	197	418541	2830	8	377
DVA.5-40-40-M8-*	40	40	M8	8	75	415851	995	10	100	413171	1403	10	140	418551	3150	10	315
DVA.5-40-50-M8-*	40	50	M8	8	90	415853	1005	13	80	413173	1397	13	112	418553	2382	13	191
DVA.5-50-20-M10-*	50	20	M10	10	77	415861	2680	5	536	413181	3460	5	692	418561	7450	5	1490
DVA.5-50-30-M10-*	50	30	M10	10	100	415871	1820	8	243	413183	2520	8	336	418571	5420	8	723
DVA.5-50-35-M10-*	50	35	M10	10	105	415876	1715	8	196	413184	2530	8	289	418576	4160	8	475
DVA.5-50-40-M10-*	50	40	M10	10	115	415881	1430	10	143	413186	2760	10	276	418581	4950	10	495
DVA.5-50-45-M10-*	50	45	M10	10	118	415883	1605	11	142	413187	2510	11	223	418583	4810	11	427
DVA.5-50-50-M10-*	50	50	M10	10	123	415886	1610	12	129	413188	2570	12	206	418586	4860	12	389
DVA.5-60-30-M10-*	60	30	M10	10	141	415891	2800	8	373	413191	4350	8	580	418591	7500	8	1000
DVA.5-60-40-M10-*	60	40	M10	10	170	415895	2600	10	260	413192	3540	10	354	418595	4640	10	464
DVA.5-60-50-M10-*	60	50	M10	10	205	415901	2900	13	232	413193	4370	13	350	418601	9500	13	760
DVA.5-70-30-M10-*	70	30	M10	10	195	415907	4930	8	657	413195	7170	8	956	418607	13070	8	1743
DVA.5-70-40-M10-*	70	40	M10	10	255	415911	3850	10	385	413196	6280	10	628	418611	15280	10	1528
DVA.5-70-45-M10-*	70	45	M10	10	275	415921	3700	11	329	413201	6750	11	600	418621	8800	11	782
DVA.5-70-55-M10-*	70	55	M10	10	341	415931	3320	14	241	413211	5770	14	420	418631	9510	14	692
DVA.5-75-25-M12-*	75	25	M12	12	205	415941	6560	5	1312	413221	9660	5	1932	418641	20780	5	4156
DVA.5-75-30-M12-*	75	30	M12	12	210	415951	5400	8	720	413226	8700	8	1160	418651	15400	8	2053
DVA.5-75-40-M12-*	75	40	M12	12	290	415961	5010	10	501	413231	6680	10	668	418661	9170	10	917
DVA.5-75-50-M12-*	75	50	M12	12	345	415971	3970	13	318	413241	5570	13	446	418671	13550	13	1084
DVA.5-75-55-M12-*	75	55	M12	12	348	415976	5050	13	367	413189	6820	13	496	418676	10590	13	770
DVA.5-100-40-M16-*	100	40	M16	16	485	415981	9430	10	943	413261	12110	10	1211	418681	24190	10	2419
DVA.5-100-50-M16-*	100	50	M16	16	580	415991	8320	13	666	413281	14040	13	1123	418691	22900	13	1832
DVA.5-100-55-M16-*	100	55	M16	16	583	415996	7820	13	568	413286	12730	13	925	418696	22800	13	1658
DVA.5-100-60-M16-*	100	60	M16	16	720	416001	7440	15	496	413291	12950	15	863	418701	21450	15	1430
DVA.5-125-55-M16-*	125	55	M16	16	1050	416021	21217	14	1543	413321	23790	13	1809	418721	23751	11	2102
DVA.5-125-75-M16-*	125	75	M16	16	1212	416031	18723	19	999	413331	22314	19	1190	418731	25000	18	1420
DVA.5-150-75-M20-*	150	75	M20	20	1325	416041	18050	18	962	413341	27800	18	1482	418741	28600	11	2600
DVA.5-200-100-M20-*	200	100	M20	20	1950	416051	9280	8	1160	413351	11540	8	1442	418761	22770	5	4554



Vibration mounts 21



DVA.5 - 10 - 10 - SST - M4 - 55
 D L Stainless steel d Shore A

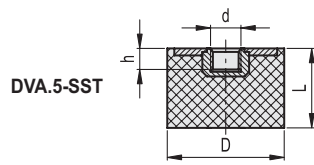

DVA.5-SST

STAINLESS STEEL

Description	D	L	d	h	△	Hardness 40 Shore A			Hardness 55 Shore A			Hardness 70 Shore A					
						Code	Max load [N]	Max deflection [mm]	Stiffness [N/mm]	Code	Max load [N]	Max deflection [mm]	Stiffness [N/mm]	Code	Max load [N]	Max deflection [mm]	Stiffness [N/mm]
DVA.5-8-8-SST-M3-55	8	8	M3	3	1		34	2	17	410398	55	2	28		141	2	71
DVA.5-8-13-SST-M3-55	8	13	M3	3	2		33	3	10	410399	52	3	16		133	3	41
DVA.5-10-10-SST-M4-55	10	10	M4	4	2		54	3	21	410401	88	3	35		217	3	87
DVA.5-10-15-SST-M4-55	10	15	M4	4	2		69	4	18	410403	92	4	25		175	4	47
DVA.5-15-15-SST-M4-55	15	15	M4	4	5		141	4	38	410405	259	4	69		384	4	102
DVA.5-15-20-SST-M4-55	15	20	M4	4	6		134	5	27	410407	223	5	45		590	5	118
DVA.5-20-15-SST-M6-55	20	15	M6	6	10		289	4	77	410413	468	4	125		704	4	188
DVA.5-20-20-SST-M6-55	20	20	M6	6	11		258	5	52	410415	367	5	73		809	5	162
DVA.5-20-25-SST-M6-55	20	25	M6	6	13		250	6	40	410417	437	6	70		750	6	120
DVA.5-20-30-SST-M6-55	20	30	M6	6	15		285	7	38	410419	410	7	55		615	7	82
DVA.5-25-15-SST-M6-55	25	15	M6	6	16		485	4	129	410421	797	4	213		1627	4	434
DVA.5-25-20-SST-M6-55	25	20	M6	6	20		416	5	83	410425	581	5	116		1382	5	276
DVA.5-25-25-SST-M6-55	25	25	M6	6	21		510	6	82	410426	635	6	102		1262	6	202
DVA.5-25-30-SST-M6-55	25	30	M6	6	21		290	8	39	410427	591	8	79		1186	8	158

DVA.5 - 10 - 10 - SST - M4 - 55
 D L Stainless steel d Shore A

DVA.5-SST

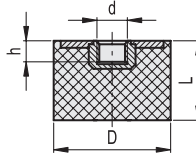

DVA.5-SST

STAINLESS STEEL

Description	D	L	d	h	△	Hardness 40 Shore A			Hardness 55 Shore A			Hardness 70 Shore A					
						Code	Max load [N]	Max deflection [mm]	Stiffness [N/mm]	Code	Max load [N]	Max deflection [mm]	Stiffness [N/mm]	Code	Max load [N]	Max deflection [mm]	Stiffness [N/mm]
DVA.5-30-15-SST-M8-55	30	15	M8	8	23		746	3	249	410431	1023	3	341		2610	3	870
DVA.5-30-17-SST-M8-55	30	17	M8	8	25		772	3	257	410433	1275	3	425		2447	3	816
DVA.5-30-20-SST-M8-55	30	20	M8	8	27		567	5	113	410435	1014	5	203		1878	5	376
DVA.5-30-25-SST-M6-55	30	25	M6	6	30		495	6	79	410436	960	6	153		1565	6	250
DVA.5-30-30-SST-M8-55	30	30	M8	8	34		601	8	80	410437	776	8	103		1616	8	215
DVA.5-30-40-SST-M8-55	30	40	M8	8	43		550	10	55	410439	780	10	78		1785	10	179
DVA.5-40-20-SST-M8-55	40	20	M8	8	45		1200	5	240	410441	2500	5	500		4750	5	950
DVA.5-40-20-SST-M10-55	40	20	M10	10	44		1115	5	223	410449	1623	5	325		5600	5	1120
DVA.5-40-30-SST-M8-55	40	30	M8	8	65		1140	8	152	410443	1480	8	197		2830	8	377
DVA.5-40-40-SST-M8-55	40	40	M8	8	75		995	10	100	410445	1403	10	140		3150	10	315
DVA.5-40-50-SST-M8-55	40	50	M8	8	90		1005	13	80	410447	1397	13	112		2382	13	191
DVA.5-50-20-SST-M10-55	50	20	M10	10	77		2680	5	536	410451	3460	5	692		7450	5	1490
DVA.5-50-30-SST-M10-55	50	30	M10	10	100		1820	8	243	410453	2520	8	336		5420	8	723
DVA.5-50-35-SST-M10-55	50	35	M10	10	105		1715	8	196	410454	2530	8	289		4160	8	475
DVA.5-50-40-SST-M10-55	50	40	M10	10	115		1430	10	143	410455	2760	10	276		4950	10	495
DVA.5-50-45-SST-M10-55	50	45	M10	10	118		1605	11	142	410457	2510	11	223		4810	11	427
DVA.5-50-50-SST-M10-55	50	50	M10	10	123		1610	12	129	410458	2570	12	206		4860	12	389
DVA.5-60-30-SST-M10-55	60	30	M10	10	141	ON REQUEST	2800	8	373	410461	4350	8	580	ON REQUEST	7500	8	1000
DVA.5-60-40-SST-M10-55	60	40	M10	10	170		2600	10	260	410462	3540	10	354		4640	10	464
DVA.5-60-50-SST-M10-55	60	50	M10	10	205		2900	13	232	410463	4370	13	350		9500	13	760
DVA.5-70-30-SST-M10-55	70	30	M10	10	195		4930	8	657	410470	7170	8	956		13070	8	1743
DVA.5-70-40-SST-M10-55	70	40	M10	10	255		3850	10	385	410471	6280	10	628		15280	10	1528
DVA.5-70-45-SST-M10-55	70	45	M10	10	275		3700	11	329	410473	6750	11	600		8800	11	782
DVA.5-70-55-SST-M10-55	70	55	M10	10	341		3320	14	241	410475	5770	14	420		9510	14	692
DVA.5-75-25-SST-M12-55	75	25	M12	12	205		6560	5	1312	410481	9660	5	1932		20780	5	4156
DVA.5-75-30-SST-M12-55	75	30	M12	12	210		5400	8	720	410483	8700	8	1160		15400	8	2053
DVA.5-75-40-SST-M12-55	75	40	M12	12	290		5010	10	501	410485	6680	10	668		9170	10	917
DVA.5-75-50-SST-M12-55	75	50	M12	12	345		3970	13	318	410487	5570	13	446		13550	13	1084
DVA.5-75-55-SST-M12-55	75	55	M12	12	348		5050	13	367	410489	6820	13	496		10590	13	770
DVA.5-100-40-SST-M16-55	100	40	M16	16	485		9430	10	943	410491	12110	10	1211		24190	10	2419
DVA.5-100-50-SST-M16-55	100	50	M16	16	580		8320	13	666	410493	14040	13	1123		22900	13	1832
DVA.5-100-55-SST-M16-55	100	55	M16	16	583		7820	13	568	410492	12730	13	925		22800	13	1658
DVA.5-100-60-SST-M16-55	100	60	M16	16	720		7440	15	496	410495	12950	15	863		21450	15	1430
DVA.5-125-55-SST-M16-55	125	55	M16	16	1050		21217	14	1543	410496	23790	13	1809		23751	11	2102
DVA.5-125-75-SST-M16-55	125	75	M16	16	1212		18723	19	999	410497	22314	19	1190		25000	18	1420
DVA.5-150-75-SST-M20-55	150	75	M20	20	1325		18050	18	962	410494	27800	18	1482		28600	11	2600
DVA.5-200-100-SST-M20-55	200	100	M20	20	1950		9280	8	1160	410498	11540	8	1442		22770	5	4554



Vibration mounts 21