

REV	ECN NO.	DATE	SIGN	DESCRIPTION
B	LEN-0C0635	2010/11/26	Ivan	Change View

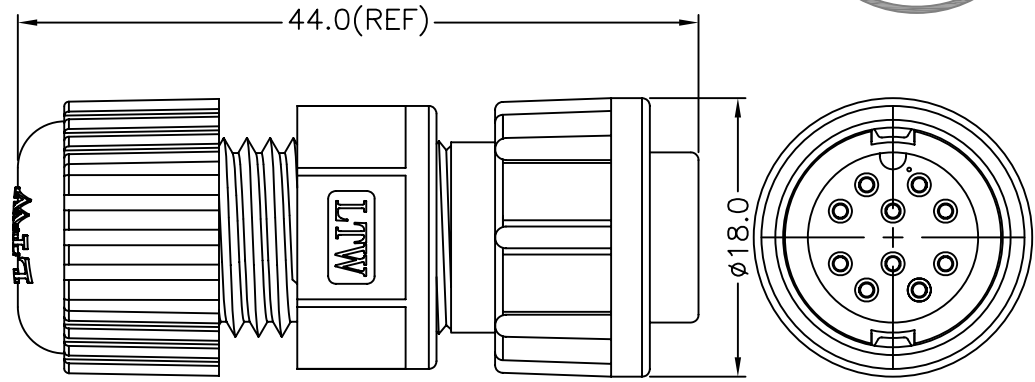
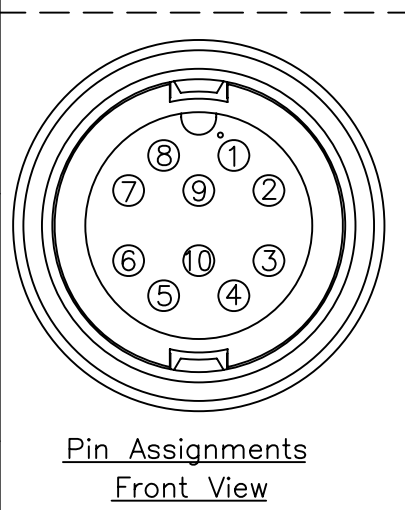
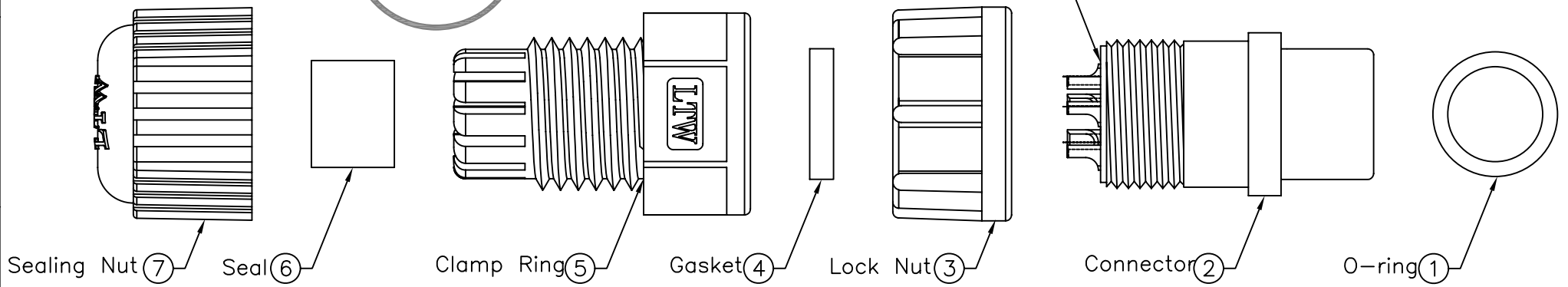
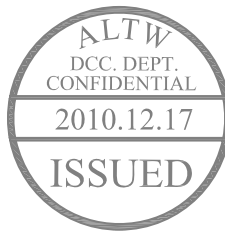

- Note:
- * @C Important Dimension To Check.
 - * Waterproof Rate: IP67
 - * Connector: Nylon+GF ,Black
 - * Female Pin: Copper Alloy, Gold Plated
 - * Lock Nut: Nylon+GF ,Black
 - * O-Ring: EPDM,Black
 - * Gasket: EPDM ,Black
 - * Seal: EPDM ,Black
 - * Clamp Ring: Nylon66 ,Black
 - * Sealing Nut: Nylon66 ,Black
 - * Seal for Cable OD: ø4.5mm~ø6.5mm
 - * One Set Unassembled in One PE Bag

UNIT:mm	
TOLERANCE	
.X	±0.25
.XX	±0.1
.XXX	±0.05
ANGLES	±1°

TITLE	Standard	
	Assy Lock 10Pin F Conn. F Pin	
SCALE	Free	SHEET 1 OF 1
REV. B	SIZE A4	@C :Inspection Item

Amphenol LTW
安費諾亮泰企業股份有限公司

ITEM NO	LTWBU-10BFFA-LL7001
DWG NO	LTWBU-10BFFA-LL7001
CUSTOMER	

DRAWN BY	Ivan
CHECKED BY	Aric
APPROVED BY	Yitung

DATE	2010/11/26
DATE	2010/11/26
DATE	2010/11/26

THIS DOCUMENT IS SUBJECT TO CHANGE WITHOUT NOTICE. IT IS CONFIDENTIAL AND A PROPERTY OF Amphenol LTW. DISCLOSURE TO THIRD PARTY HAS TO BE AUTHORIZED BY Amphenol LTW.