

# TERMINAL BLOCK MARKERS TYPE DK<sup>®</sup>

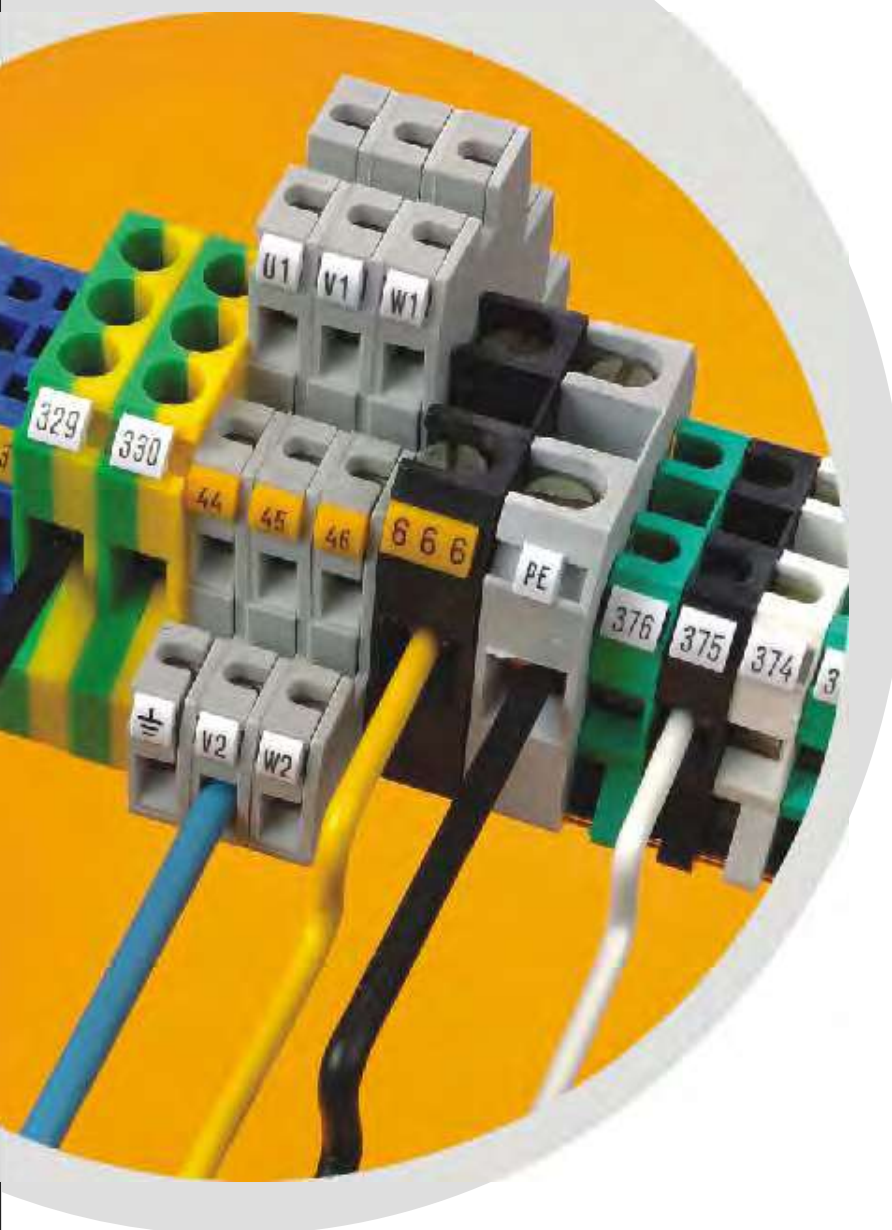

## DESCRIPTION :

Terminal Markers Type **DK<sup>®</sup>** are resistant to most chemicals, oils, acids, common cleaning solvents and solutions. Durable imprint produced using our proprietary technology guarantees longevity and good abrasion resistance by embedding the print within a layer of clear PVC. Terminal Markers Type **DK<sup>®</sup>** are self-extinguishing and successfully passed a full cycle flammability tests conducted according to Underwriters Laboratories Inc. Standard UL 1581 Method VW-1 as confirmed by a Test Report. Markers **DK<sup>®</sup>-Z5** (5mm width) fit a maximum of 2 characters, markers **DK<sup>®</sup>-Z6** (6mm width) fit a maximum of 3 characters.

## MATERIAL :

PVC (polyvinyl chloride)

## COLOUR :

Yellow marker with black imprint.

Custom colours available upon request.

## APPLICATIONS :

Terminal Markers **DK<sup>®</sup>** fit terminal blocks made by: SE "POKÓJ" Łódź, SIMET SA Jelenia Góra, ELEKTROBUDOWA Mikołów, PHOENIX-CONTACT (terminal blocks type UK-2,5B), WEIDMUELLER (terminal blocks series SAK), ENTRELEC (terminal blocks type MA 2,5/5) and many others.

## THERMAL PROPERTIES :

Temperature range: continuous -30°C up to +100°C

## FLAMMABILITY :

Self-extinguishing - UL 1581:2001 Method VW-1

## TESTS AND CERTIFICATION :

Meets the requirements of the European Directive 2002/95/EC (RoHS) ) dated January 27, 2003, restricting the use of some substances within electrical and electronic equipment.

Certificate of Conformance - Biuro Badawcze Jakości - SEP, Certificate of Conformance with IEC European Standard 60.227-BBJ-SEP, Centrum Techniki Okrętowej - Gdańsk, Certificate - Energoprojekt Poznań, Certificate - Polski Rejestr Statków

**PACKAGING :** Standard packaging: 1000, 500 and 250 pcs. strips of pre-cut markers (all with same imprint) for easy detaching of individual pieces.

## print symbols

### standard offer

0, 1, 2, 3, 4, ..... 9  
A, B, C, D, ..... Z  
a, b, c, d, ..... z  
L1, L2, L3, PE, PEN  
+ - ~ = . , : /

numbers, uppercase letters  
lowercase letters, symbols,  
signs

### custom orders

1, 2, 3, 4, ..... 10  
11, 12, 13, ..... 20  
21, 22, 23, ..... 30  
391, 392, ..... 400  
10, 20, 30, ..... 100

Note: Terminal Markers DK-Z5  
include numbers  
1 - 100

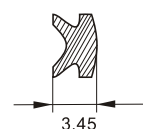

marker  
profile

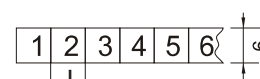

L - pitch  
L = 5,8 - 6mm for DK/Z6  
L = 4,8 - 5mm for DK/Z5