

REV.	ECN NO.	DATE	SIGN	DESCRIPTION
B	LE3-960038	2009/06/22	Prune	Change The Note And 螺牙

THIS DOCUMENT IS SUBJECT TO CHANGE WITHOUT NOTICE. IT IS CONFIDENTIAL AND A PROPERTY OF AMPHENOL LTW. DISCLOSURE TO THIRD PARTY HAS TO BE AUTHORIZED BY AMPHENOL LTW.

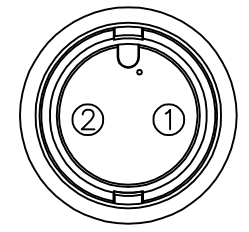
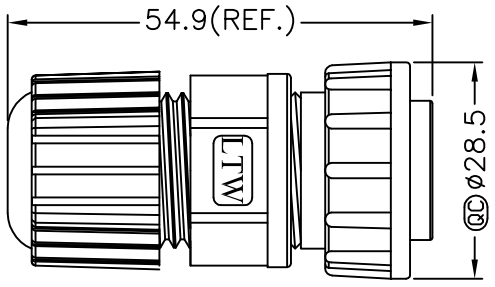
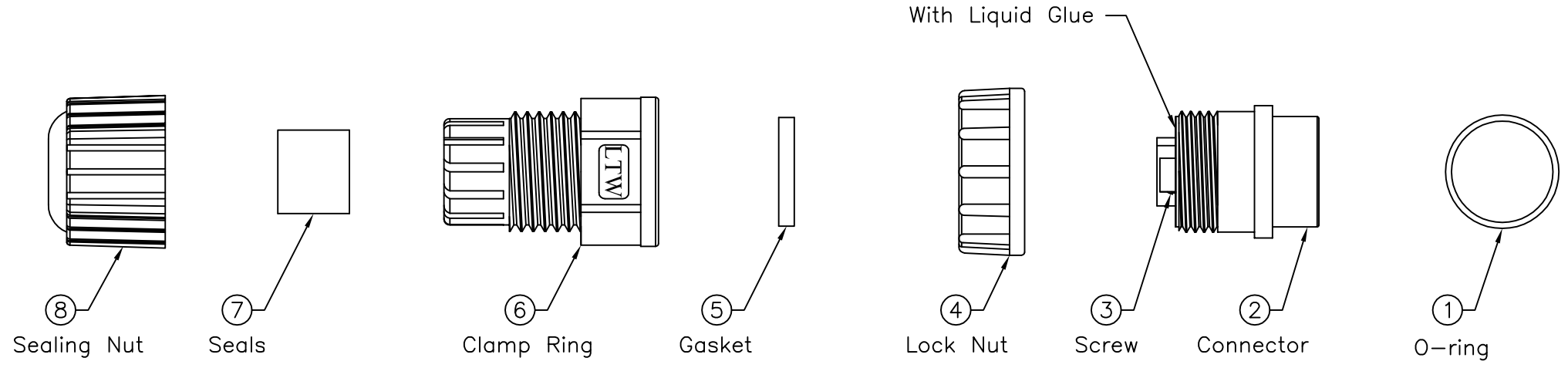

Pin Assignments
Front View

ALTW
CONFIDENTIAL
2009.06.22
R&D DEPT.

ALTW
DCC. DEPT.
CONFIDENTIAL
2009.06.29
ISSUED

- Note:
- * @C Important Dimension To Check.
 - * Waterproof Rate: IP67
 - * Housing: Nylon+GF
 - * Pin: Copper Alloy, Gold Plated
 - * Liquid Glue: Clear
 - * Screw: Stainless Steel
 - * Ring: Black, EPDM
 - * Nut: Black, Nylon+GF
 - * Gasket: Black, Silicone
 - * Clamping Ring: Black, Nylon
 - * Seals: Black, EPDM
 - * Sealing Nut: Black, Nylon
 - * Seals for Cable OD: $\phi 5.5\text{m} \sim \phi 10.8\text{mm}$
 - * One Set Unassembled in One PE Bag
 - * Application AWG: 14~16AWG

PE Pag ⑨

UNIT:mm		TITLE	Large		ITEM NO	DC-02BFFB-LL7001	DRAWN BY	Prune	DATE	2009/06/22	
TOLERANCE	$\pm 0.5\text{ mm}$	Assy Lock 2Pin F Conn F Pin			DWG NO	DC-02BFFB-LL7001	CHECKED BY	Tina	DATE	2009/06/22	
		SCALE	Free	SHEET	1 OF 1	CUSTOMER	ALTW	APPROVED BY	LUKE	DATE	2009/06/22
		REV.	B	SIZE	A4						
					@C	:Inspection Item					

Amphenol LTW
安費諾亮泰企業股份有限公司