

## CW-18 series

### Characteristic

CW-18 series single turn potentiometers are enclosed in a tight metal housing, with a cermet resistive element, which is characterized by a greater durability than a typical carbon track. Elements have a linear characteristic of regulation. Potentiometers can be manufactured in a hermetic housing ("H" marking). Potentiometers with 5% and 10% resistance tolerance are available on request.

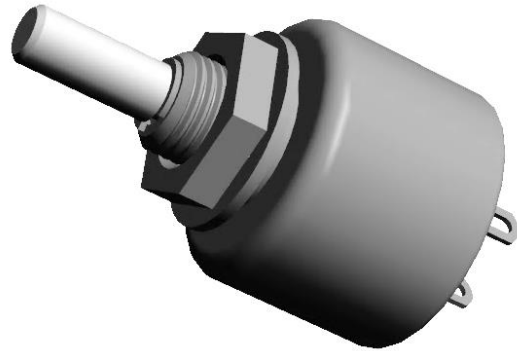

<u>Parameter</u>	<u>Value</u>	
Nominal resistance	E6 series	
Range of available resistances	100Ω ... 4,7MΩ	
Resistance tolerance	R ≤ 470 kΩ	±20%
	R > 470 kΩ	±30%
Max. dissipation power (T = 40°C)	1 W	
Max. operating voltage	350 V	
Mechanical rotation angle	240° ±10°	
Electrical rotation angle	230° ±10°	
Climatic category	55/100/56	

### Dimensions

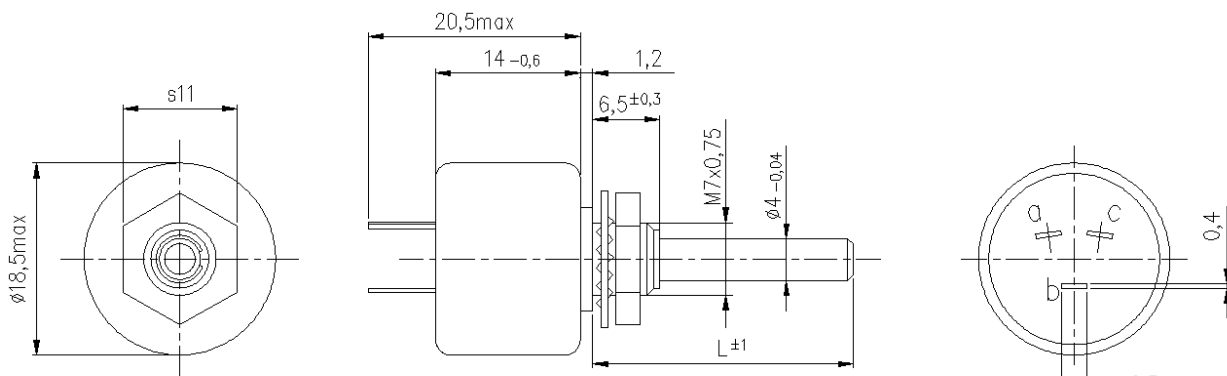

### TELPOD S.A.

str. Pilsudskiego 63A  
32-050 Skawina  
[www.telpod.pl](http://www.telpod.pl)

Technical division: +48 (0)12 257 10 12  
Sales division: +48 (0)12 257 10 35  
fax: +48 (0)12 257 10 13  
e-mail: [potentiometer@telpod.pl](mailto:potentiometer@telpod.pl)

date: 04 / 2015  
Copyright 2015 by Telpod

## CW-18 series

### Shaft types

Type	Length L [mm]
P1	16; 20; 25
P3	12; 16; 20; 25
P5	12; 16; 20; 25

