

## BN 785

Serrated lock washers  
large type, internal serrated

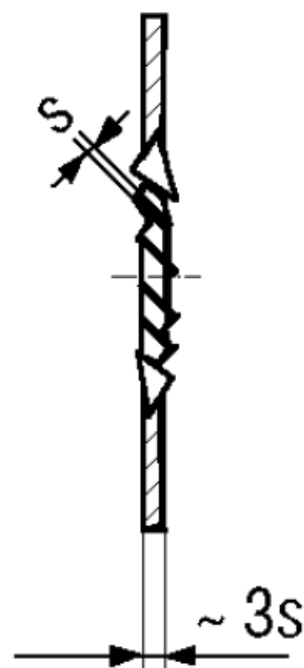
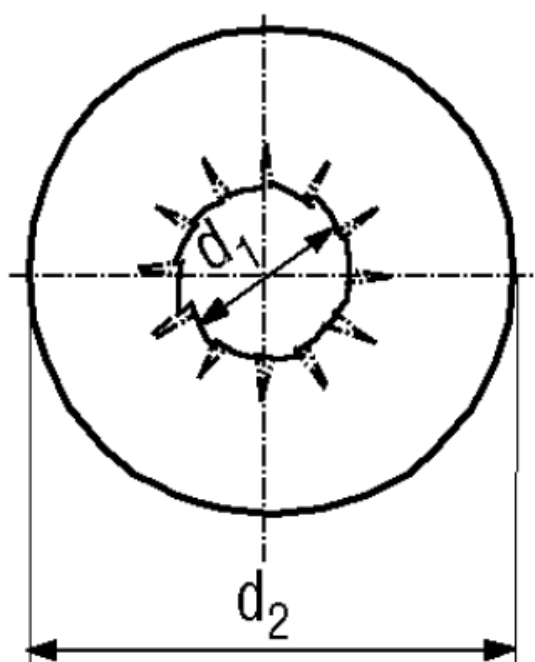

Type	JZC	Surface	zinc plated blue
Material	Spring steel	Hardness	420-510 HV

Article No. - 1278614	
for thread	M6
$d_2$ max.	14,2
s	0,7
$d_1$ min.	6,1

Spring elements  $\geq 320$  HV electroplated coatings: Susceptible to hydrogen embrittlement!  
Other coatings on request.

Used for bridging slots and grooves. Used when the teeth should be invisible for aesthetic reasons.