

EAO – Your Expert Partner for Human Machine Interfaces

82-6151.1114 - Illuminated pushbutton 22 mm stainless-steel, momentary

82-6151.1114 - Illuminated pushbutton 22 mm stainless-steel, momentary



Attention: The preview is based on a sample product. This can differ from your current configuration.

Mounting

Mounting cut-out Ø 22,3 mm
Design flush

Front

Front dimension Ø 25 mm
Front shape round
Front ring shape flush
Front bezel material Stainless steel

Other Attributes

Operating voltage 24 V AC/DC
Weight 0,018 kg
Operation current 7 mA

Operating-/Indication part

Lens optics opaque
Lens material Stainless steel
Lens profile flat
Lens illumination illuminative
Lens colour Stainless steel

IP-Rating

Front protection IP65, IP67

Connection Method

Terminal Solder 2.8 x 0.5 mm

Actuator

Switching action Momentary

Switching element

Switching current 3 A
Contact material Silver
Contacts 1 C
Switching system Snap-action switching element
Switching voltage 240 V AC/DC

Illumination

Illumination Ring with red LED

Function

Illuminated pushbutton

EAO – Your Expert Partner for Human Machine Interfaces

82-6151.1114 - Illuminated pushbutton 22 mm stainless-steel, momentary

Dimensions

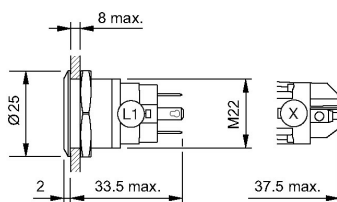

Mounting cut-outs

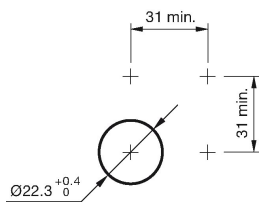

Wiring diagram

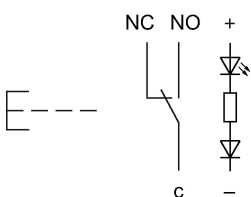

Component layout



Legend

Switching action: B = Momentary
Contacts: C = Changeover