

Data sheet Indicator 19 mm.

Part No.: 82-5151.0114

Technical data



Terminal	Soldering terminal, 0.5 x 2.8 mm
Shape of illumination	Ring
Operating voltage	24 V AC/DC
Lens illumination	illuminative
Lens colour	Silver
Lens shape	flush
Lens material	Stainless steel
Lens optics	opaque
Front bezel shape	flush
Front bezel material	Stainless steel
Weight	0.018 kg
Illumination colour	Red
Kind of illumination	Single-LED
Operating temperature	- 30 °C ... + 70 °C
Approbations	CB, CCC, C UL, UL
Climate resistance	Damp heat, 21 days according to IEC 60512-11

Dimensions

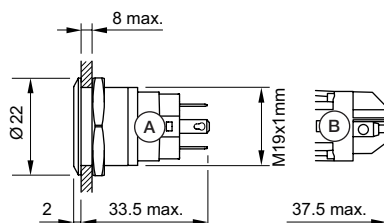

A = Solder terminal
B = Screw terminal

Mounting cut-outs

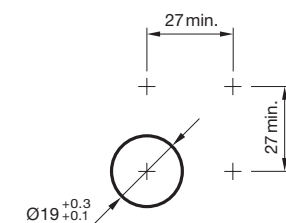

Wiring diagrams

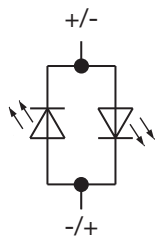

Component layouts

