

LOC		DIST		REVISIONS				
P	LTR	DESCRIPTION	DATE	DMN	APVD			
D1		REVISED PER ECO-11-004835	11MAR11	RK	HMR			

1. MATERIAL:
 HOUSING – POLYESTER MOLDING COMPOUND, COLOR: BLACK
 TERMINALS – 0.35[.0138] THICK PHOS BRONZE PLATED WITH 1.27 μ m[.000050] MIN THICK GOLD IN LOCALIZED AREA AND 3.81 μ m[.000150] MIN THICK MATTE TIN IN SOLDER AREA OVER 1.27 μ m[.000050] MIN THICK NICKEL UNDERPLATE
 SHIELD – COPPER ZINC ALLOY PLATED WITH 3.0 μ m [.000120] MIN THICK REFLOWED TIN.

\triangle 2 CAVITY CONFORMS TO FCC RULES AND REGULATIONS PART 68 AND REA BULLETIN 345-81, PE-76 SPECIFICATION FOR MODULAR TELEPHONE HARDWARE.

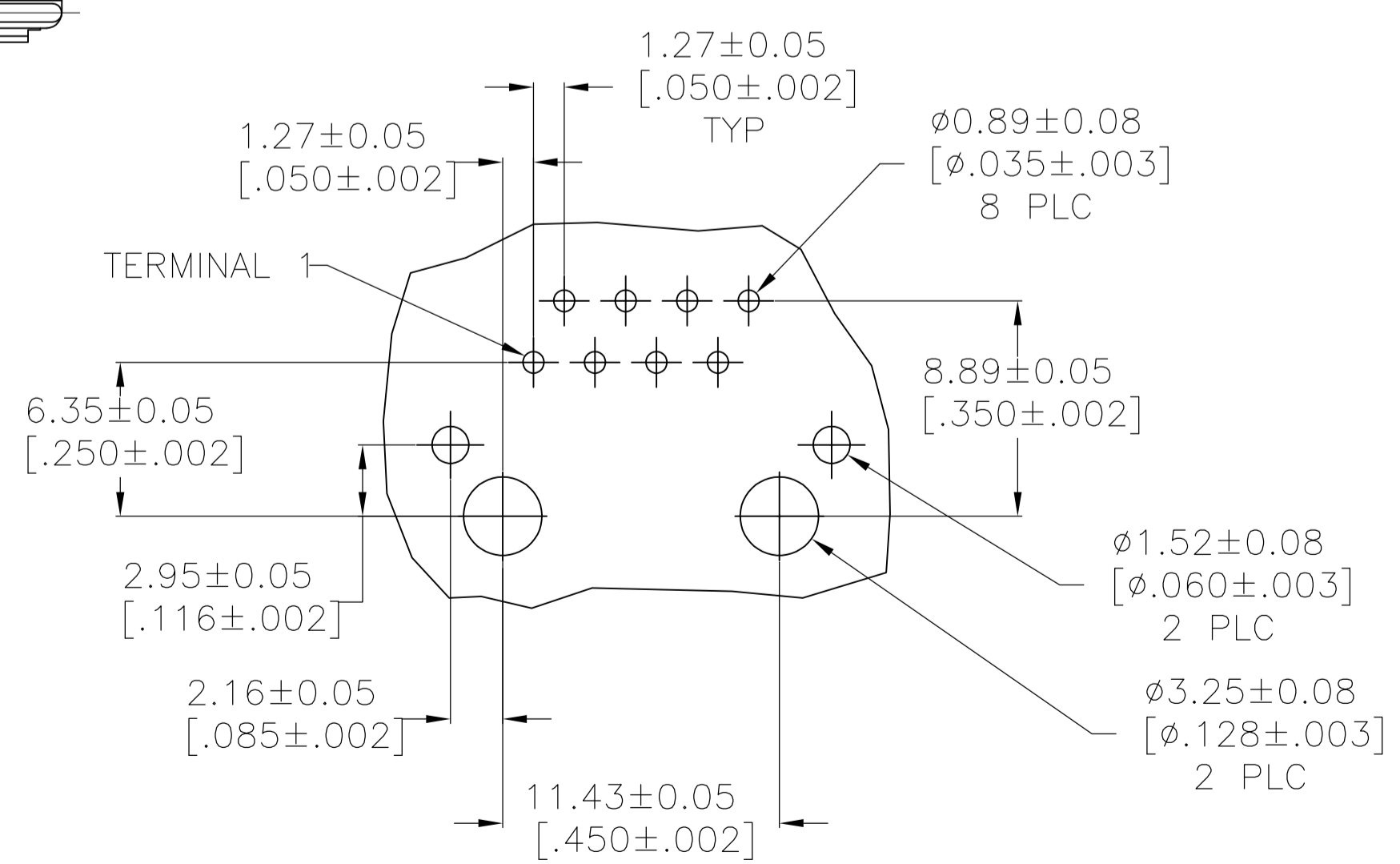
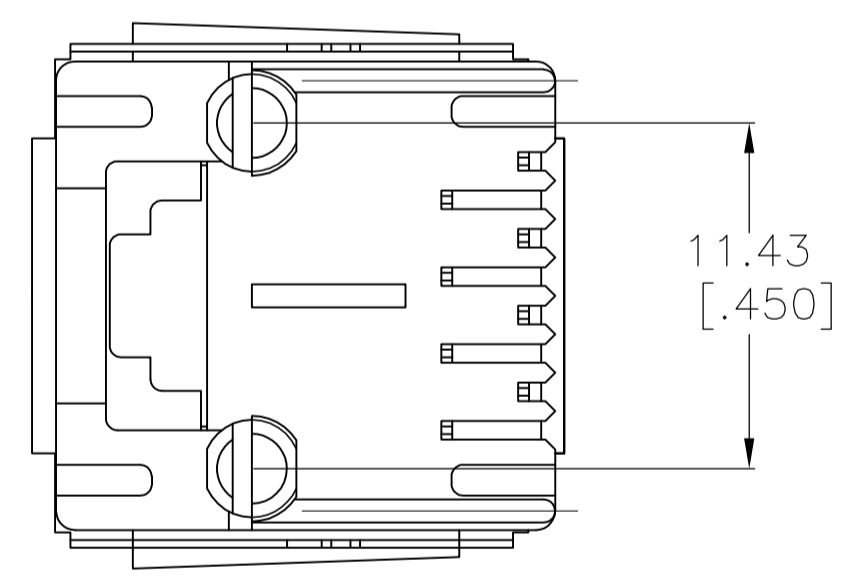
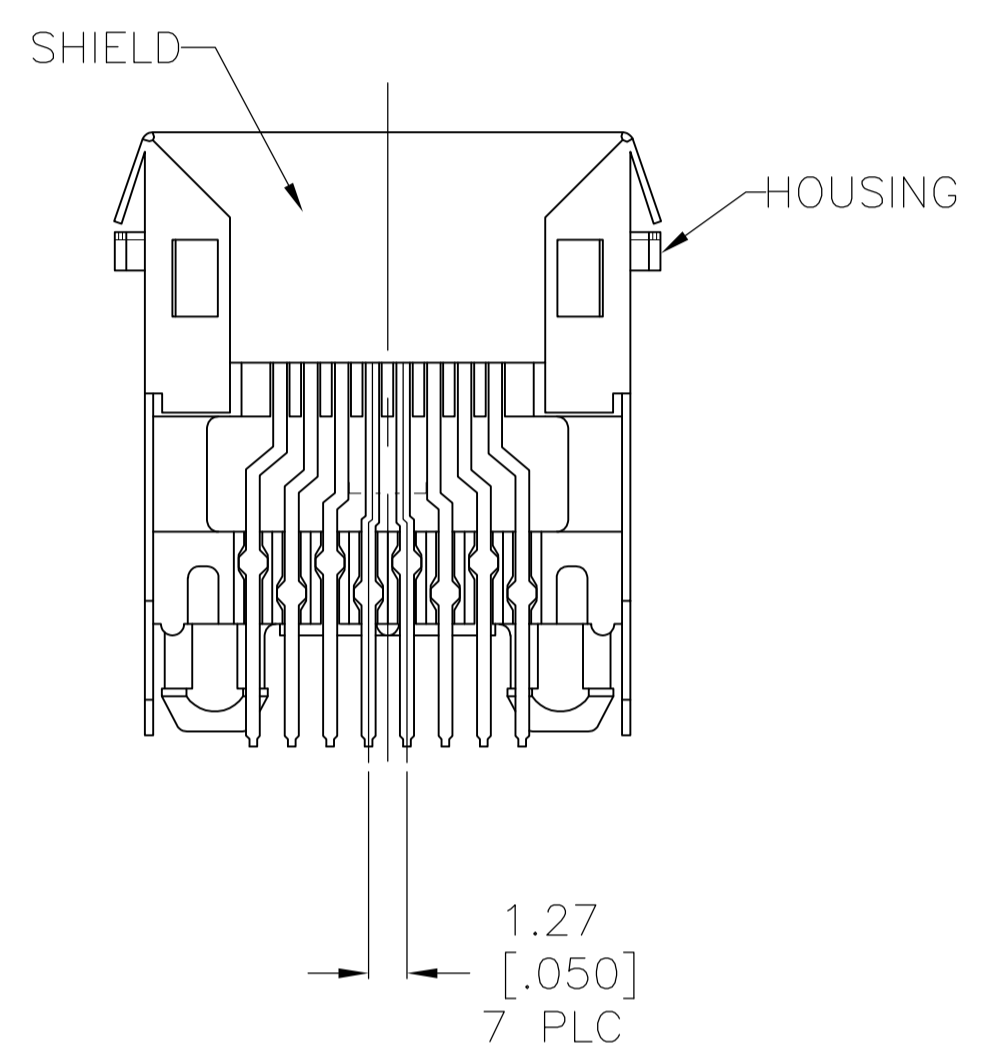
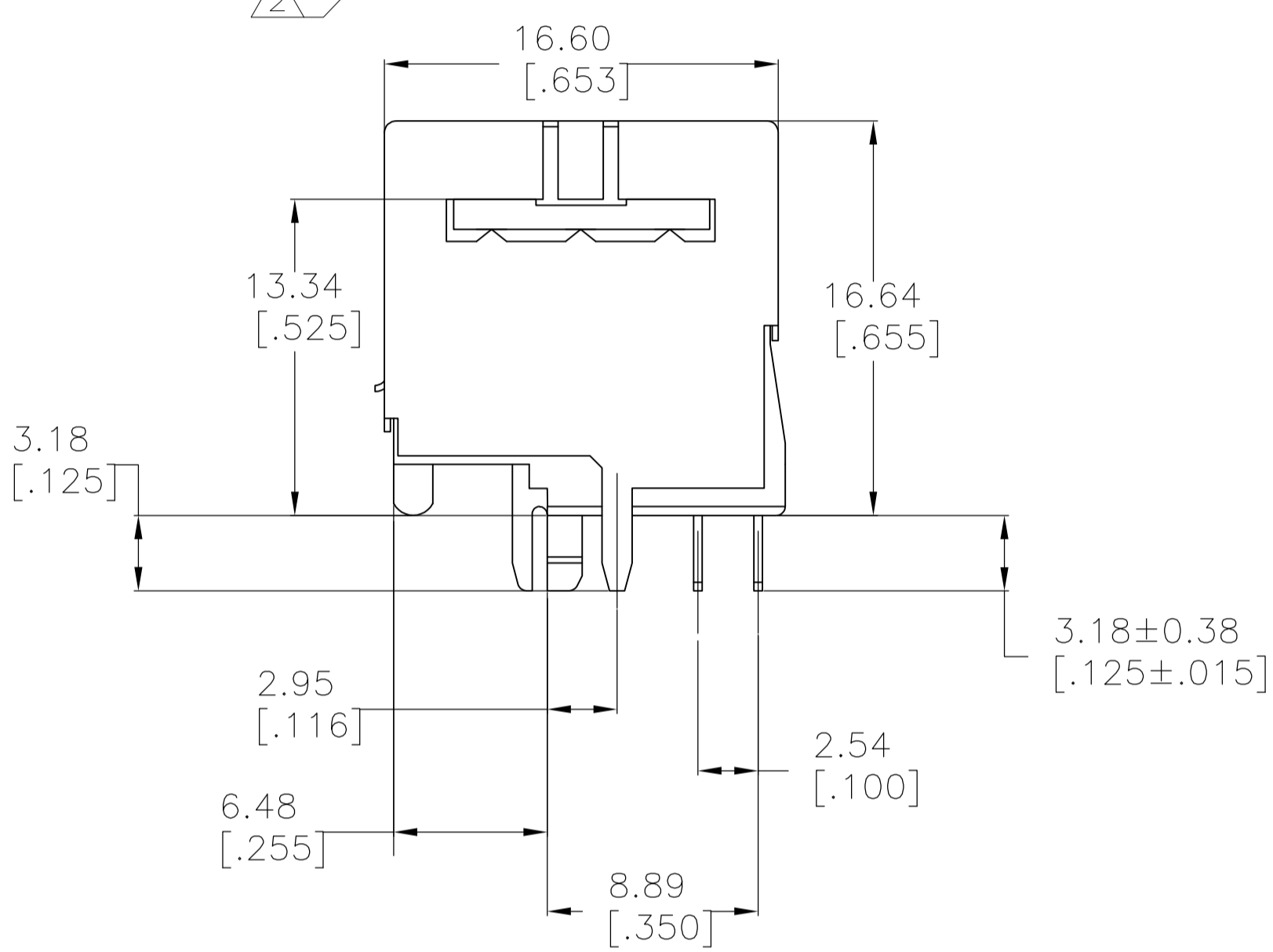
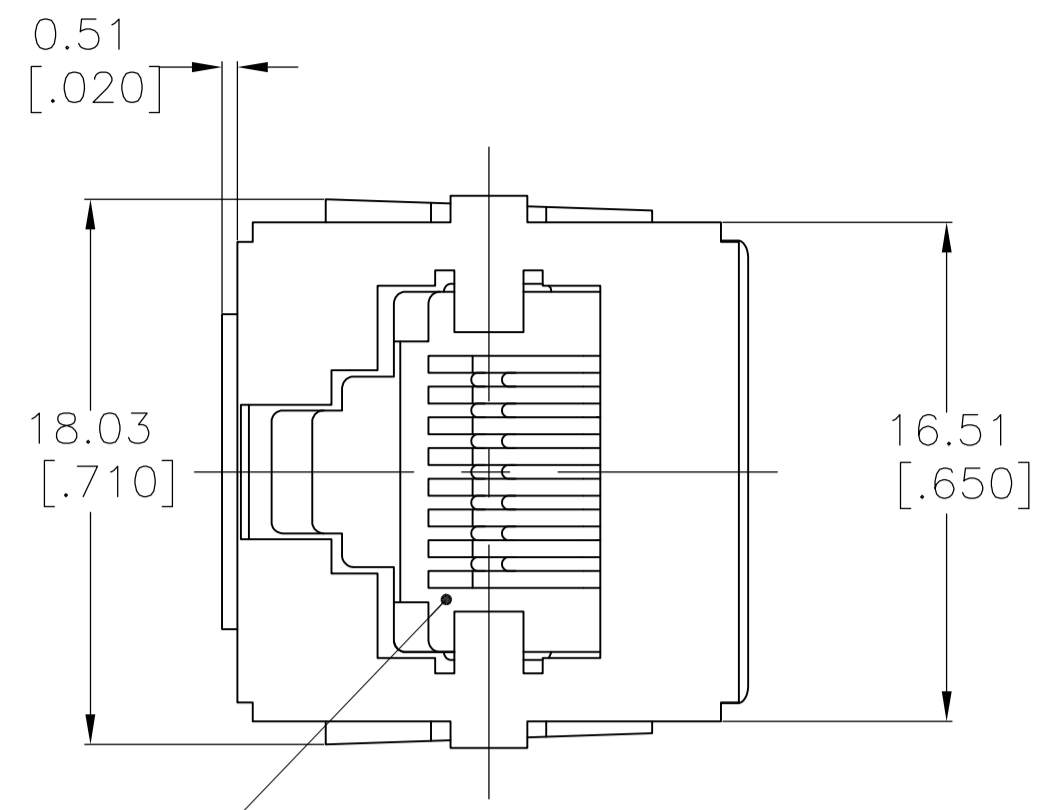

RECOMMENDED PRINTED CIRCUIT BOARD LAYOUT COMPONENT SIDE SHOWN

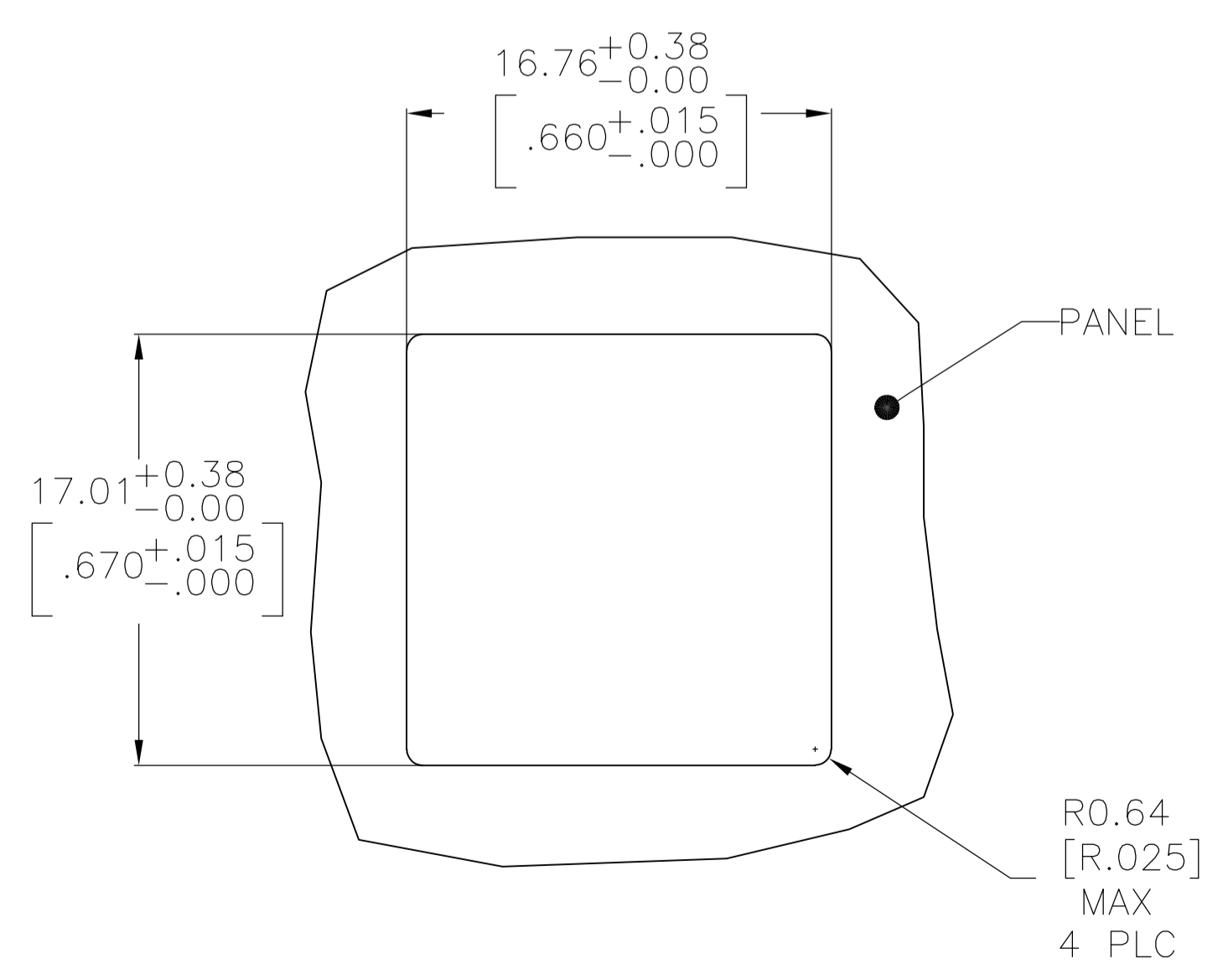

RECOMMENDED PANEL CUTOUT

5406436-1
PART NO.

THIS DRAWING IS A CONTROLLED DOCUMENT.		DIN	J. ALCORTA - 09JUN2005	TE Connectivity
DIMENSIONS: mm [INCHES]		CHK	J. WESTMAN 09JUN2005	
TOLERANCES UNLESS OTHERWISE SPECIFIED:	0 PLC	±	APVD	S. FLICKINGER 09JUN2005 NAME PRODUCT SPEC 108-1163 APPLICATION SPEC 114-2048
	1 PLC	±	SIZE	
	2 PLC	±	CAGE CODE	DRAWING NO A1 00779
	3 PLC	±	SCALE	
	4 PLC	±	WEIGHT	SHEET 1 OF 1 REV D1
	ANGLES	±	CUSTOMER DRAWING	