

DATE	DESCRIPTION	REV.
5.09.11	CHANGE AS PER ECN 11-062	A
5.18.11	CHANGE AS PER ECN 110-066	B
5.29.11	CHANGE AS PER ECN 110-089	C
8.09.11	CHANGE AS PER ECN 11-102	D
3.15.12	CHANGE AS PER ECN 12-032	E
7.24.14	CHANGE AS PER ECN 14-079	F

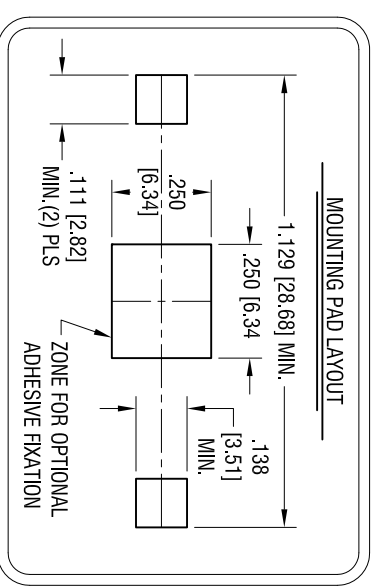
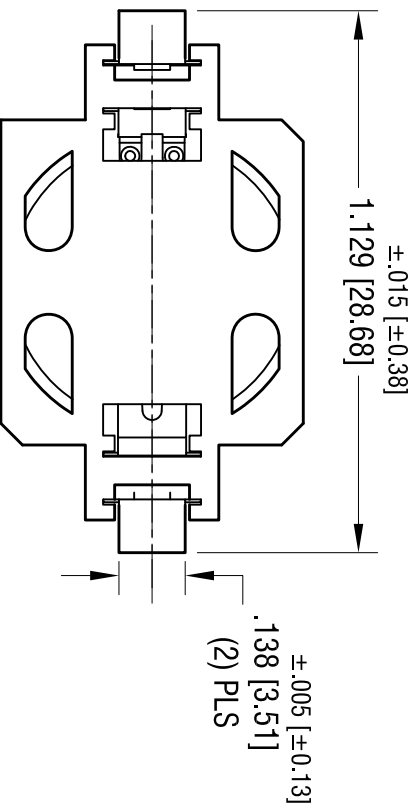
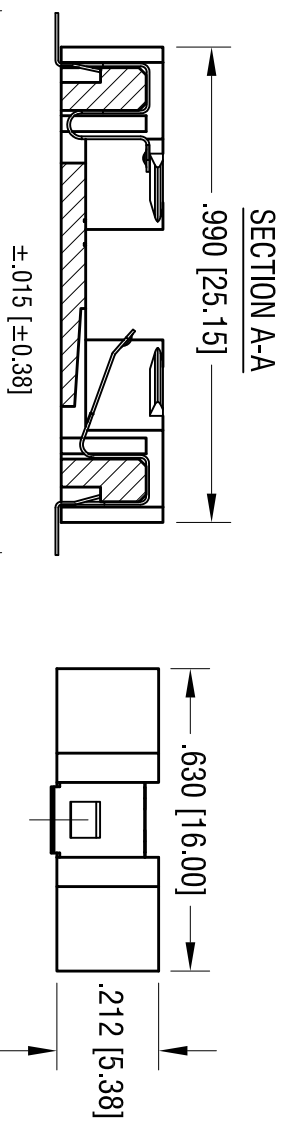
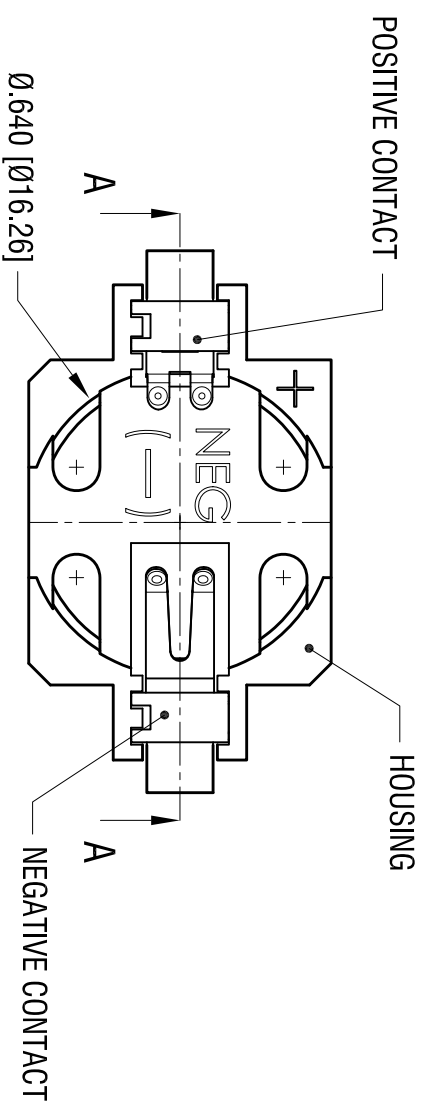

**KEYSTONE ELECTRONICS CORP.**

www.keystone.com • ASTORIA, N.Y. 11105-2017 • Tel (718) 956-8900

PART NAME

1632 SMT BATTERY HOLDER

MATERIAL

AS NOTED

FINISH

AS NOTED

DRN BY: NT DATE: 11.30.10

App'D: LN SCALE: 2.5X

TOLERANCES INCH [MM] DECIMAL ± .010 [± 0.25] ANGULAR ± 1°

UNLESS OTHERWISE SPECIFIED

CODE C

DWG NO. 504

POSITIVE CONTACT

HOUSING

NEGATIVE CONTACT

SECTION A-A

NOTES:

1. BASE:

MAT'L - GLASS FILLED LCP UL 94V-0

2. CONTACTS:

MAT'L - .006 [0.15] THK PHOSPHOR BRONZE

FINISH: GOLD FLASH PLATING

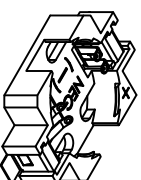

ACTUAL SIZE

THIS DOCUMENT IS THE PROPERTY OF KEYSTONE ELECTRONICS CORP. AND SHALL NOT BE REPRODUCED, DISTRIBUTED OR USED AS A BASIS FOR MANUFACTURE WITHOUT PRIOR WRITTEN PERMISSION FROM KEYSTONE ELECTRONICS CORP.