

Technical data sheet

Locknut, metric thread with cutting teeth

Item no. 2091713



Locknuts DIN 46319 with metric thread IEC 423.
* Prices according to DEL notation.



CuZn	Brass
N	Nickel-plated

Master data

Item no.	2091713
Type	169 MSS M20
Description 1	Locknut
Description 2	with cutting teeth
Dimension	M20x1,5
Material	Brass
Material symbol	CuZn
Surface	Nickel-plated
Surface symbol	N
Smallest sales unit (VG)	50,00 Piece
Weight	0,76 kg/100 pc.

Technical data

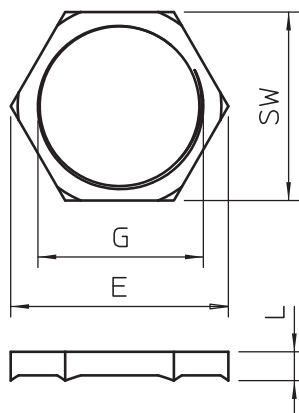

Dimension E	27,70 mm
Dimension h	5,50 mm
Dimension L	4,50 mm
WAF	24,00 mm
Thread type	Metric
Thread	M20x1,5
Nominal thread size metric/PG	20,00
Fibre-glass reinforced	<input type="checkbox"/>
Halogen-free	<input type="checkbox"/>
Impact-resistant	<input type="checkbox"/>