

400 V

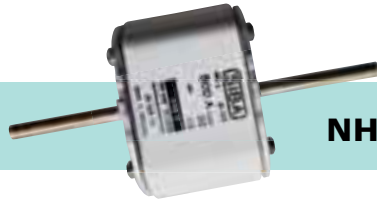

NH 4a

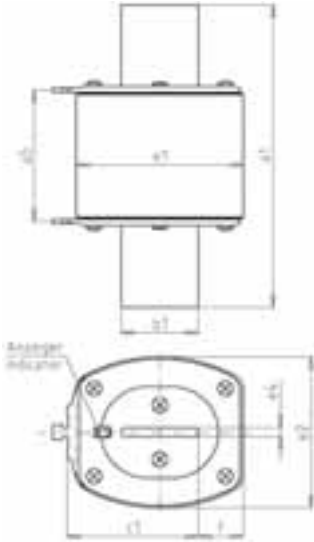

Spannungsführende Griffflaschen / Non insulated removal tags

Verpackung / Packing 1 Stück / 1 piece

Betriebsklasse / Class  
gTr

VDE 0636 Teil 2011

| Bemes-<br>sungs-<br>spannung<br>Rated<br>Voltage | Artikel<br>Article | Größe<br>Size | Transforma-<br>tor-Nenn-<br>strom<br>Transformer<br>Current | Länge<br>Length |                |                |                |                |                |    |                |    |    |    |
|--|--------------------|---------------|---|-----------------|----------------|----------------|----------------|----------------|----------------|----|----------------|----|----|----|
|  |                    |               |   | a <sub>5</sub>  | a <sub>1</sub> | b <sub>1</sub> | e <sub>4</sub> | e <sub>1</sub> | e <sub>2</sub> | f  | c <sub>1</sub> | h  | i  |    |
| V  |                    |               | I <sub>rat</sub> / A  | mm              | mm             | mm             | mm             | mm             | mm             | mm | mm             | mm | mm | mm |
| 400  | 20 482 15          | NH 4a         | 72 - 1443   | 87              | 200            | 50             | 6              | 108            | 100            | 28 | 85             | -  | -  |    |

| Transformator-<br>Nennleistung<br>Rated Transformer<br>Capacity | Transformator-<br>Nennstrom<br>Transformer<br>Current | Artikel Nr. / Leistungsabgabe<br>Article No. / Power Loss |     | Gewicht<br>Weight | Bemessungs-<br>ausschaltvermögen<br>Rated Breaking<br>Capacity | Schmelzintegral<br>Pre-Arcing-<br>i <sup>2</sup> t <sub>s</sub> -Value | Ausschaltintegral<br>Total i <sup>2</sup> t <sub>a</sub> -Value |                  |
|---|---|---|-----|-------------------|--|--|---|------------------|
|   |   | NH 4a   | W   |                   |  |  | @ AC 254 V  | @ AC 400 V       |
| kVA   | I <sub>rat</sub> / A                                  |   |     | kg/1              | kA   | A <sup>2</sup> s   | A <sup>2</sup> s  | A <sup>2</sup> s |
| 50  | 72  | 20 482 15.72  | 8,5 | 2,65              | 100  | 6.950  | 10.950  | 15.800           |
| 75  | 108   | 20 482 15.108   | 11  | 2,65              | 100  | 18.900   | 30.700  | 44.000           |
| 100   | 144   | 20 482 15.144   | 13  | 2,65              | 100  | 35.700   | 58.000  | 84.000           |
| 125   | 180   | 20 482 15.180   | 15  | 2,65              | 100  | 76.000   | 124.000   | 173.000          |
| 160   | 231   | 20 482 15.231   | 18  | 2,65              | 100  | 139.600  | 227.000   | 326.000          |
| 200   | 289   | 20 482 15.289   | 22  | 2,65              | 100  | 226.600  | 368.000   | 514.000          |
| 250   | 361   | 20 482 15.361   | 27  | 2,65              | 100  | 415.400  | 695.000   | 970.000          |
| 315   | 455   | 20 482 15.455   | 33  | 2,65              | 100  | 738.600  | 1.200.000   | 1.674.000        |
| 400   | 577   | 20 482 15.577   | 38  | 2,65              | 100  | 1.247.000  | 2.133.000   | 2.976.000        |
| 500   | 722   | 20 482 15.722   | 51  | 2,65              | 100  | 2.199.000  | 3.570.000   | 4.982.000        |
| 630   | 909   | 20 482 15.909   | 72  | 2,65              | 100  | 3.910.000  | 6.348.000   | 9.000.000        |
| 800   | 1.155   | 20 482 15.1155  | 86  | 2,65              | 100  | 7.613.000  | 12.362.000  | 16.737.000       |
| 1.000   | 1.443   | 20 482 15.1443  | 110 | 2,65              | 100  | 13.135.000   | 21.330.000  | 29.770.000       |

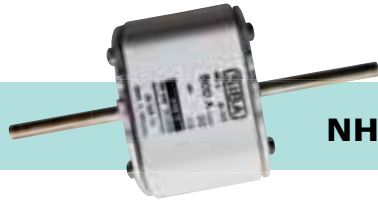

400 V

NH 4a

gTr

Zeit/Strom-  
Kennlinien  
Time-current  
characteristics

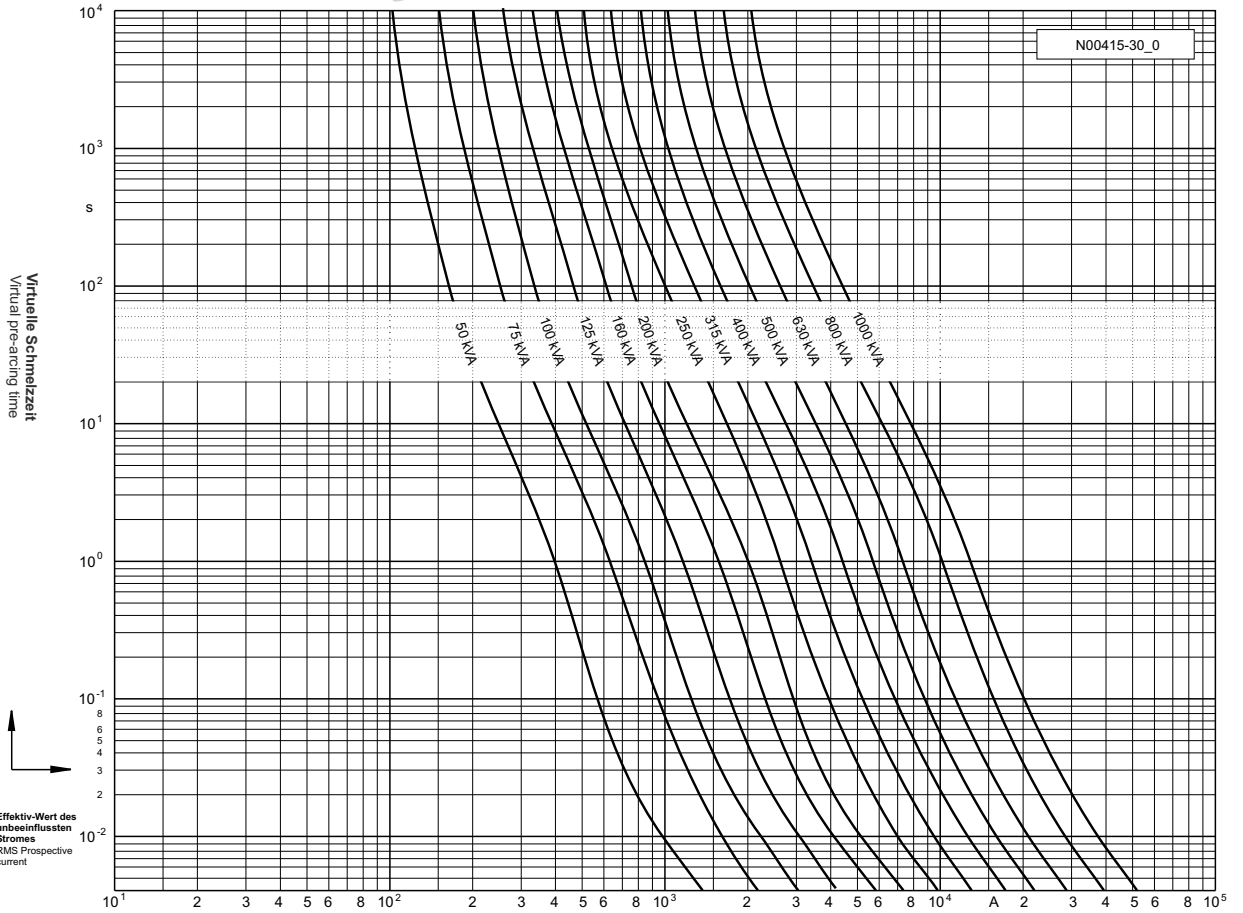

Durchlass-Strom  
Cut-off current

