

Bellows suction cup HT2 (round)

SAB 50 HT2-65 G1/4-IG

Part no...:10.01.06.03451

<https://www.schmalz.com/10.01.06.03451>

Home > Vacuum Technology for Automation > Vacuum Components > Vacuum Suction Cups > Suction Cups for Handling Sheet Metal > Bellows Suction Cups SAB HT2 (1.5 Folds) > SAB 50 HT2-65 G1/4-IG

Bellows suction cup (round) for handling hot workpieces



Size: 50

Suction cup material: High temp material HT2

Material hardness [Shore A]: 65 Shore A

Temperature resistance: 200 °C

Nipple material: Aluminum

Connection: G1/4-IG

Number of folds: 1.5

Design Data

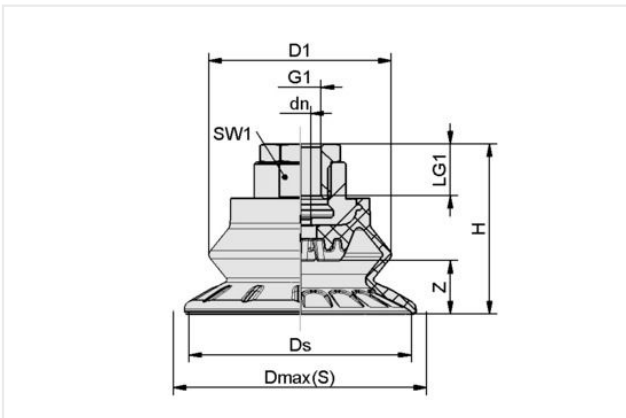

Attribute	Value
dn	6 mm
D1	42.10 mm
Dmax(S)	56 mm
Ds	50.20 mm
G1	G1/4"-F
H	41.90 mm
LG1	20 mm
SW1	22 mm
Z (Stroke)	11.50 mm

Technical Data

Attribute	Value
Suction force (-600mbar)	53 N
Pull-off force	91 N
Lateral force	102 N
Volume	18.90 cm ³
Curve radius (min) (convex)	25 mm
Hose diameter (empf.) d	6 mm
Size	50
Connection	G1/4"-F

Contact Schmalz

Schmalz Sp.z.o.o. | ul. Fabianowska 131/A1, 62-052 Komorniki, Poland | +48 61 628 67 70 | schmalz@schmalz.pl



Bellows suction cup HT2 (round)

SAB 50 HT2-65 G1/4-IG

Part no...:10.01.06.03451

<https://www.schmalz.com/10.01.06.03451>

Suction cup material	High temp material HT2
Material hardness [Shore A]	65 Shore A
Weight	52.10 g
Number of folds	1.50
Product family	SAB

Contact Schmalz

Schmalz Sp.z.o.o. | ul. Fabianowska 131/A1, 62-052 Komorniki, Poland | +48 61 628 67 70 | schmalz@schmalz.pl