

## Flat suction cup (round)

SUF 20 HT1-60 SC030

Part no...:10.01.01.13991

<https://www.schmalz.com/10.01.01.13991>

Home > Vacuum Technology for Automation > Vacuum Components > Vacuum Suction Cups > Flat Suction Cups (Round) > SUF 20 HT1-60 SC030

### Flat suction cup (round) f. process- safe handling of smooth or slightly rough surfaces



Size: 20

Suction cup material: High temp material HT1

Material hardness [Shore A]: 60 Shore A

### Design Data

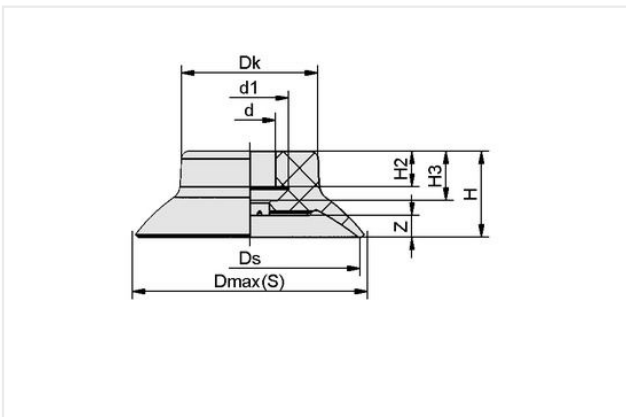

Attribute	Value
d1	7.30 mm
d	5.30 mm
Dk	12.50 mm
Dmax(S)	22.80 mm
Ds	20 mm
H	9.50 mm
H2	4.30 mm
H3	5.80 mm
Z (Stroke)	2 mm

### Technical Data

Attribute	Value
Suction force (-600mbar)	15 N
Pull-off force	15 N
Volume	0.50 cm <sup>3</sup>
Curve radius (min) (convex)	20 mm
Size	20
Nipple family	SC030
Suction cup material	High temp material HT1
Material hardness [Shore A]	60 Shore A
Weight	1.50 g

### Contact Schmalz

Schmalz Sp.z.o.o. | ul. Fabianowska 131/A1, 62-052 Komorniki, Poland | +48 61 628 67 70 | [schmalz@schmalz.pl](mailto:schmalz@schmalz.pl)

## Flat suction cup (round)

SUF 20 HT1-60 SC030

Part no...:10.01.01.13991

<https://www.schmalz.com/10.01.01.13991>

Product family

SUF

### Accessories



#### SC 030 G1/8-AG

Part no...:10.01.06.04288

Connection geometry: 030

Vacuum connection: G1/8"-M

Fitting length: 6 mm

Nominal diameter dn: 3.1 mm



#### SC 030 G1/8-IG

Part no...:10.01.06.04307

Connection geometry: 030

Vacuum connection: G1/8"-F

Fitting length: 14 mm

Nominal diameter dn: 3.1 mm